

SCENIC°

THE ORIENTAL
WONDERS OF
JAPAN &
SOUTH KOREA



2023/2024

scenic.co.uk

Welcome

Scenic has been setting the benchmark in luxury land journeys for over 37 years, proudly placing the guest experience at the heart of every decision we make.

Explore the natural and ancient wonders of Japan and South Korea on a fully inclusive, handcrafted land journey, enjoying a thoughtfully curated selection of iconic hotel stays and exclusive experiences. Be immersed in once-in-a-lifetime Scenic Enrich moments for a true insight into the culture of these nations, and personalise your journey by choosing from a range of carefully selected, flexible Scenic Freechoice activities, from poignant World War memorials to spiritual temples and pagodas.

Your dedicated Scenic Tour Director is on hand to ensure you'll experience the very best your destination has to offer, so you can simply relax and enjoy each day's awe-inspiring discoveries.

It's more than the finest accommodation. It's spectacular locations and signature creature comforts.

It's more than daily sightseeing excursions. It's exclusively curated once-in-a-lifetime captivating Scenic Enrich moments.

It's more than gourmet dining and beverages. It's a culinary celebration through authentic local and global cuisine.

It's more than flexible touring. It's days spent broadening your horizons through included Scenic Freechoice excursions.

It's more than transporting you from point A to point B. It's seamless travel, arriving refreshed from the ease of your journey.

It's more than small group travel. It's unparalleled access at a comfortable pace, while creating lasting connections with like-minded people.

With Scenic, it's more than an escorted tour. It's a handcrafted land journey in a class of its own.

Join us in 2023 or 2024 and let Japan and South Korea's ancient history, natural beauty and traditions capture your sense of wonder.



DISCOVER

The Far East has always conjured an image of mystical and exotic faraway lands shrouded in mystery and allure. Embark on a memorable journey of enlightenment and discover the different cultures, natural wonders and innovative spirit of the people of Japan and South Korea.



Japan

Comprising over 3,000 islands steeped in history, Japan also impresses as a glittering industrial powerhouse. Here, ancient disciplines and time-honoured rituals are harmoniously integrated into the familiar rush of modern daily life. From the bright lights of its great cities to serene rural sanctuaries and powerful natural landscapes, feel the excitement of experiencing these contrasts.

South Korea

Tucked away between the cutting-edge world of Japan and the isolated land of North Korea, is the treasure trove of South Korea. Mystical ancient temples, rolling tea plantations, charming fishing villages, yellow fields of rapeseed flowers and cities that never sleep make it an enlightening and ever-exciting journey.

Journeys & Cruises Overview

Land Journeys

Japan

⌚ Duration	📍 Destinations	Land Journey / Cruise & Code	Page
16 Day	Japan in Focus Tokyo > Osaka	Land Journey DJPO	24
20 Day	Essential Japan Tokyo > Osaka	Land Journey DJPS	28
17 Day	Japan Unveiled NEW Fukuoka > Tokyo	Land Journey DJFT	34
16 Day	Hidden Wonders of North Japan Tokyo > Sapporo	Land Journey DJTS	38

South Korea

12 Day	The Soul of South Korea Seoul > Seoul	Land Journey DSKS	46
--------	---	-----------------------------	----

Ultimate Journeys

25 Day	Japan & South Korea in Focus Tokyo > Seoul	Land Journey DJSK	50
--------	--	-----------------------------	----

South East Asia River Cruising

⌚ Duration	📍 Destinations	Land Journey / Cruise & Code	Page
28 Day	Luxury Mekong & Japan in Focus Siem Reap > Osaka	Land Journey & Cruise DIJP	56

5-STAR LUXURY LAND JOURNEYS

With Scenic, the perks and privileges come included. Enjoy a range of luxurious benefits that will enhance your experience throughout your journey in Asia.

- Return flights from a selection of UK airports
- Fully escorted small group touring with a maximum of 24 guests
- Scenic Enrich – unforgettable and exclusive once-in-a-lifetime experiences
- Scenic Freechoice – a range of included activities and dining options to personalise your journey
- Scenic Sunset Drinks – exclusive hosted evening drinks in memorable locations
- Scenic Special Stays – iconic hotels remarkable for their location, character and heritage
- Business or First Class high speed train travel in Japan and South Korea
- All internal flights included
- Welcome and farewell receptions with complimentary drinks
- Handpicked Tour Directors and expert local guides
- Personal audio headsets for commentary in Japan and South Korea
- A Scenic representative to assist you on your arrival and departure
- Return airport transfers
- Health and Safety policies – hotels and experiences selected for your wellbeing

With Scenic it's more than an escorted tour, it's a handcrafted luxury land journey in a class of its own.





CONNECT WITH US



Connect with us and your fellow travellers. Share your stories and photos via Facebook @ScenicUK, Twitter @ScenicLuxury, Instagram @scenic.luxurycruisestours and subscribe to YouTube ScenicUK. We regularly post information and updates about our vast choice of destinations and experiences, so it's also a great way to keep in touch with the latest news at Scenic.

- A Scenic Freechoice – Haedong Yonggungsa Temple, South Korea
- B Scenic Enrich – Performance of Seungmu, Gyeongju, South Korea
- C Small groups of no more than 24 guests
- D Capitol Hotel Tokyu, Tokyo, Japan

To speak to our friendly and expert team call 0808 258 3966



THE SCENIC DIFFERENCE



At Scenic, we've combined the ease of luxury travel with carefully curated experiences, that offer a true insight into the culture and unique natural wonders of Japan and South Korea.

It's more than daily sightseeing excursions, it's seamlessly exploring these fascinating countries whilst enjoying exclusively curated once-in-a-lifetime Scenic Enrich moments. It's knowing everything is taken care of, with your expert Tour Director, local guides and all supporting staff going above and beyond, to make your experience truly unforgettable.

From personalising your journey with a choice of flexible Scenic Freechoice activities, to enjoying luxurious accommodation and exclusive access to your destination's most remarkable places, you'll find the Scenic Difference is in the details.

OUR COMMITMENT TO A SUSTAINABLE FUTURE

Scenic's Cherish the Planet ethos is a commitment to creating positive change through sustainable practices and rich community partnerships.

Built in accordance with the United Nations Sustainable Development Goals, our sustainability agenda reinforces our commitment to environmentally responsible tourism and protecting the places we visit.

We aim to leave as small a footprint as possible while proudly forming positive and enriching associations with the communities we visit.

To learn more about Cherish the Planet, visit scenic.co.uk/why-scenic/cherish-the-planet



- A Torii gates, Fushimi Inari Shrine, Kyoto, Japan
- B Shinkansen train, Japan
- C Local expert Tour Directors

CLICK HERE for the latest offers and up to date availability, or contact your local Travel Agent



Our expertise in curating handcrafted land journeys ensures remarkable moments of wonder and a seamless travel experience.

Tour Directors

Your expert Tour Director will manage each element of your journey to ensure a smooth day-to-day running so you can enjoy everything listed in your itinerary at an enjoyable pace. They work to exceed your expectations – so much so that the most common feedback we get from our guests is praise for the caring, efficient and passionate nature of their work, a true point of difference when travelling with Scenic.

Scenic Enrich

With Scenic, you can enjoy exclusive access and experiences that are off-limits to other travellers. Relish private shows and performances for unique and enlightening moments, such as a culturally immersive evening with a geiko and a maiko in Kyoto.

Scenic Freechoice

Choose from a range of all-inclusive Scenic Freechoice experiences and personalise your journey to suit your pace and interests. Enjoy a vast range of included activities, sightseeing and dining experiences. From history to culture, cuisine to nature, relaxed or active pace, there's always something for everyone.

Iconic Hotels

Take a front-row seat to awe-inspiring vistas and memorable experiences while enjoying the most spectacular accommodation. Scenic Special Stays feature a choice of remarkable hotels notable for their location, character and heritage. At every point of your journey in Japan and South Korea, you can look forward to a luxurious sanctuary that will enrich your experience.

Unforgettable Rail Journeys

Travelling on Japan and South Korea's punctual, state-of-the-art high-speed rail system and Shinkansen bullet trains is a highlight for many Scenic guests. With Green Class (Business) seats in Japan and First-Class seats on the KTX in South Korea, you can expect a smooth ride as the wondrous scenery passes by.

The Nth Degree

Travel with the confidence of knowing every detail is taken care of to the Nth Degree. Enjoy extraordinary wonder moments while we manage all the transfers, tipping, bookings, touring and accommodation. All your transport and tours with expert local guides are carefully selected to reflect Scenic's excellence.

To speak to our friendly and expert team call 0808 258 3966



Scenic Enrich

○ *Enjoy exclusive Scenic Enrich events, taking you behind the scenes for truly immersive moments you will treasure forever.*

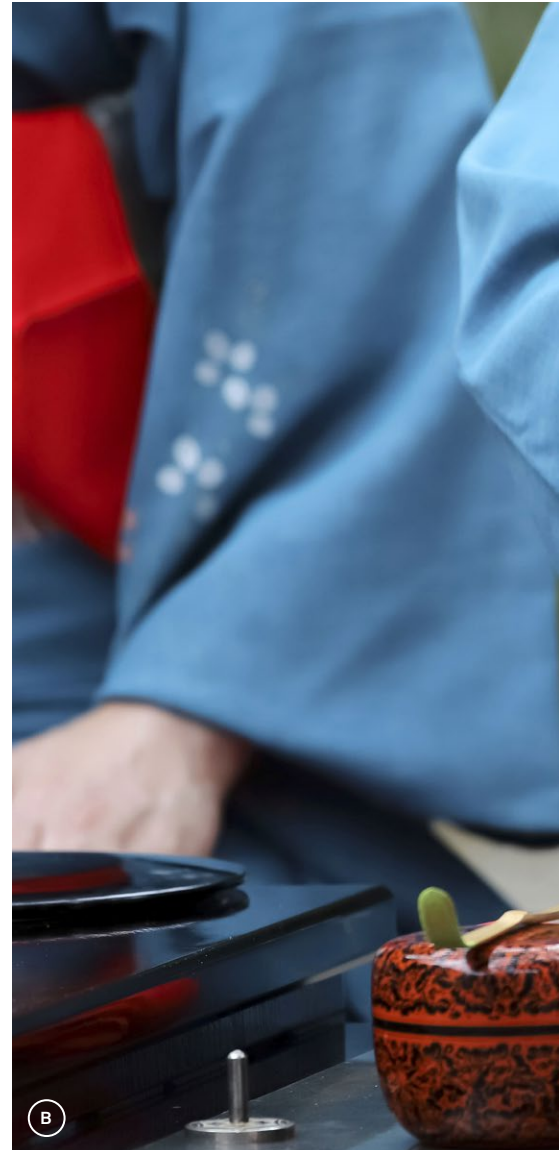

“*Highly recommended – would return at the drop of a hat. As usual, Scenic hits the mark all the way through from pre-travel organisation to delivery to our doorstep when we arrived home.*”

Russell S, Scenic Guest
Feefo Review



- A Enjoy a private dinner at a Hanok, Seoul, South Korea
- B Partake in a Traditional Tea Ceremony, Japan
- C Sumo demonstration, Japan
- D Learn to play Taiko drums, Japan

CLICK HERE for the latest offers and up to date availability, or contact your local Travel Agent



It's more than special events. It's enriching experiences that will enhance your understanding and appreciation of the incredible places, cultures and histories you'll encounter.

Enjoy a private dinner with a geiko or maiko in Japan and discover exactly what's involved in becoming a geisha. Visit the Sumo Museum in Kehayazam, where sumo originated, and partake in a private group demonstration and learn to play the traditional Taiko drums.

Japan is also famous for its unique and refined handicrafts and homewares. During specially curated Scenic Enrich events, you'll have the opportunity to be immersed in creative and interactive experiences. In Otaru, learn the art of glassblowing. Create a stunning Oirase lamp in Lake Towada and paint your own kokeshi dolls in Matsushima, both truly unique keepsakes from your time in Japan.

In South Korea, you'll experience hands-on activities such as witnessing Seungmu, a Korean dance performed by Buddhist monks at Bulguksa temple, and crafting your own mini Gayageum, a well-known zither-like 12-string Korean musical instrument.

Designed to take you into the cultural heart of your destination, Scenic Enrich events are unique moments that will truly enrich your journey.



To speak to our friendly and expert team call 0808 258 3966



Scenic Freechoice



Philosopher's Walk, Kyoto, Japan

It's more than included excursions. It's days exploring to your tastes and pace. Scenic Freechoice allows you to personalise your journey and pursue your interests at a pace that suits you.

Whether you are interested in exploring temples and gardens or indulging in the local cuisine and street markets, our comprehensive range of Scenic Freechoice activities offers something for everyone.

Enjoy an array of dining options through Scenic Freechoice Dining, from an authentic izakaya bar experience in Tokyo to dining in unique locations, such as a converted art gallery in South Korea. And of course, they're all included.

Each guest is different, so we appreciate that you may want to move at your own pace. Perhaps you'll want to follow a busy day with one at a more relaxed pace, or you may wish to truly unwind throughout.

We've divided our extensive list of Scenic Freechoice activities into active, moderate and relaxed pace so you can choose those which best suit your requirements and interests.

■■■ **Active** – For the more adventurous, keen to explore further afield or take part in more energetic excursions.

■■■ **Moderate** – A comfortable walking pace at which you can easily discover a beautiful city or marketplace.

■■■ **Relaxed** – A slower pace to enjoy a museum or brewery visit.

JAPAN

Tokyo

Cultural Shinjuku and Gyoen Gardens

Stroll through Shinjuku-Gyoen Gardens, one of the most beautiful areas for cherry blossoms in Tokyo. Visit Shinjuku's shopping and entertainment districts. ■■■

Meiji Shrine and Shibuya Crossing

Explore the tranquil evergreen forest of the Meiji Shrine complex, before walking across the busiest pedestrian crossing in the world and seeing the famous Hachiko dog statue in Shibuya. ■■■

Osaka

Historical Osaka

Learn about the history of the area by visiting the Museum of History and Osaka Castle. Originally built in the late 16th century, war and fires have led to it being rebuilt many times. ■■■

Osaka Walking Tour NEW

After catching the Metro, walk through Shinsaibashi-suji shopping avenue, a 600-metre roofed arcade of countless shops, perfect for those last minute gift purchases. Move to the nearby Kuromon Ichiba Market. An excellent location for strolling, sampling, and snacking on a delicious variety of fresh market foods. ■■■

Kyoto

Ancient Kyoto

Revel in the atmosphere of Kyoto's ancient preservation districts on the southern Higashiyama walk, strolling through Ishibei Koji, Sannen-zaka and Ninen-zaka lanes. ■■■

Philosopher's Walk

Visit the Silver Pavilion and then stroll along the Philosopher's Walk, one of Kyoto's best known spots for cherry trees, particularly beautiful during blossom season. ■■■

Fukuoka

Uminonakamichi Seaside Park

For the more adventurous, enjoy a self-guided bike ride around Uminonakamichi Seaside Park, known for its seasonal flowers. ■■■

Fukuoka Highlights

Travel to the top of Fukuoka Tower for views over the city and harbour plus wander around picturesque Maizuru Park with its Fukuoka castle ruins. ■■■

Sendai

Kirin Icban Brewery Tour

Visit the Kirin Brewery to discover the special production methods and the secret behind the premium flavour. See, touch and taste the materials and finished product as you view the production processes of this famous beer and whiskey. ■■■

Sendai City Museum of History and Folklore

Learn all about the history of the Date Clan in the Edo period including viewing the Date Masamune's armour, weaponry and works of art encompassing 400 years of Sendai history. ■■■

Sapporo

Shiroi Koibito Park

Indulge your sweet tooth at Shiroi Koibito Park, which features a chocolate factory, shop and museum where you can get one of Sapporo's famous souvenirs, the Shiroi Koibito cookie. ■■■

Sapporo Beer Museum

Explore the long history of Sapporo Beer, passed down from the days of the 1876 Kaitakushi business. Learn about the history of the famous beer, taste one of the original brews and visit the attached beer halls and museum shop. ■■■

SOUTH KOREA

Busan

Gamcheon Culture Village

Wander through Gamcheon Culture Village, once a poor mountainside community that has been transformed into an art hotspot. The area is known for its steep streets, twisting alleys, incredible art pieces, jaw-dropping views and brightly painted houses, which have been restored and enhanced in recent years. ■■■

Taejongdae Park Rocky Cliff

Ride the Danubi Train around Taejongdae Rocky Cliff Park, famous for its seascapes of steep rocky cliffs and the rock beach. The train route has five stops for various lookouts, including the Yeongdo lighthouse. ■■■

Haedong Yonggungsa Temple

Visit Haedong Yonggungsa Temple, a seaside Buddhist temple offering beautiful views over the sea. Originally built in 1376 and rebuilt in 1930 in dedication to the goddess of Buddha, make your way down 108 symbolic steps to arrive at the main temple. ■■■



Japanese cuisine

Scenic

Freechoice Dining

From casual to more formal dining, from local to global cuisine, you'll find all your needs catered to with a wealth of fantastic Scenic Freechoice Dining options.

JAPAN

Kyoto

Gion Sekiya

Located in the Gion district, this restaurant serves Japanese cuisine, including Kaiseki (traditional multi-course meal).

Fortune Garden

Built in 1927 by architect Goichi Takeda, and featuring an internal atrium with garden and koi pond, Fortune Garden offers world-class international dishes.

Takayama

Sakana Irori

A restaurant located in town known for its Hida Beef.

Sakanaya

A scenic Japanese restaurant set in a renovated former sake brewery. Try shabushabu, sukiyaki or steak, created using locally sourced seasonal ingredients.

Tokyo

Ninja Akasaka

This popular but unusual restaurant has an underlying ninja theme to create a memorable dining experience with ninja-themed Japanese food and surrounds. Throughout the evening, the ninjas ensure that you are kept entertained with various tableside demonstrations and magic tricks.

Izakaya Nightlife

With your Tour Director, sample a Yakitori and Kushiyaki dinner over some drinks at a selection of small local bars. A chance to mingle and dine in a traditional Japanese way.

Aomori

Tonkatsu Aki Restaurant

If you're a keen carnivore, this is the restaurant for you. Visit Tonkatsu Aki, where the signature dish is crumbed pork cutlets (katsu teishoku) and deliciously thin steak.

Local Izakaya

Dine at one of Aomori's local izakaya restaurants and bars.

SOUTH KOREA

Busan

Italian Fine Dining

Enjoy fine Italian dining at this converted art gallery with a view, Kitchen Dongbaek. The best Italian in Busan, choose classics from an à la carte menu.

Korean delicacies

Sample the culinary specialities of Busan at Daedo restaurant. Experience the finest cuts of cube steak, sirloin and rib eye or the famous pan fried tender beef roll.

○ *Our expert Journey Designers have handpicked every hotel to ensure you enjoy an outstanding location and luxury.*

- A Hotel de Yama, Hakone, Japan
- B Lotte Hotel Seoul, South Korea
- C Capitol Hotel Tokyu, Tokyo, Japan
- D Hanamaki Onsen Kashoen, Iwate, Japan



Scenic Special Stays



The Hoshino Resorts Oirase Keiryu Hotel is the only hotel located overlooking the Oirase Keiryu mountain stream, one of the most scenic locations in Japan and part of the Towada-Hachimantai National Park. Only a short drive along the stream, Lake Towada is the largest caldera lake on Honshu and particularly known for its Autumn foliage. Surrounded by pristine nature, enjoy a special two-night stay in the hotel that is designed around the great natural wonder of Oirase.

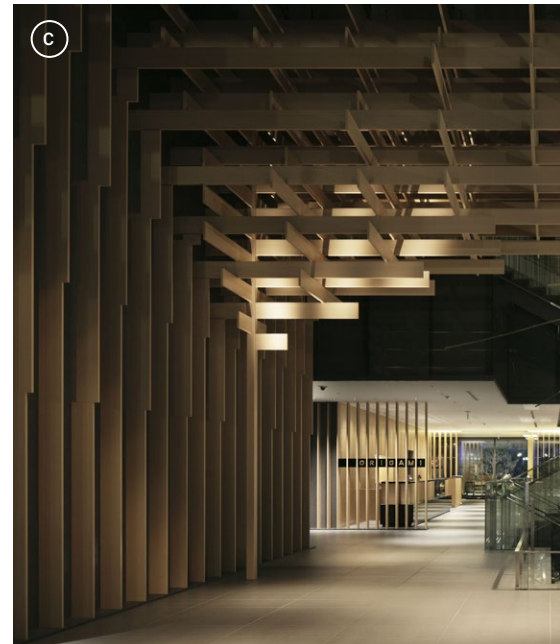



Scenic Hotels



You'll find the wonders of Japan and South Korea are even more enthralling when you're ensconced in the comfort and luxury of the region's most prestigious hotels. Unrivalled quality and service are integral to everything we do, and our selection of luxury accommodation will ensure that your land journey is just that little bit more extraordinary.

The handpicked selection of Scenic Special Stays features a choice of remarkable hotels notable for their location, character and heritage, some of which are so iconic they have become destinations in their own right.

In Japan, the accent is on design and innovation as much as it is on luxury and location. Having acquired a Forbes Travel Guide 5-star luxury award, the Capitol Hotel Tokyu offers rooms boasting traditional Japanese-style architecture for a refined modern ambiance overlooking a panoramic view of Tokyo city and the palace grounds. In Hakone, soak in the views over the beautiful gardens and Lake Ashinoko from Hotel de Yama.

In Kanazawa, enjoy the modern facilities at the newly opened Hyatt Centric Kanazawa. Located just seconds from the city's train station, this trendy hotel offers spacious rooms with modern furnishings overlooking the city, whilst its design reflects the history of the Kanazawa region.

In Hiroshima, the Hilton hotel is within walking distance of the World Heritage Atomic Bomb Dome and downtown, perfect for independent exploration.

Enjoy exclusive club access to the Executive Tower at the Lotte Hotel Seoul, located in the exciting city centre. Then, stay at InterContinental Seoul COEX in the famous Gangnam District for a 5-star experience amid some of South Korea's most celebrated attractions.

At Hanamaki Onsen Kashoen, guests can choose to stay in a traditional Futon Japanese or western-style room. Either way, you will be immersed in the peaceful mountain and forest surroundings. Stay in the Executive rooms at Hilton Osaka, the perfect location from which to explore the amazing modern city.

At every point of your journey, you can look forward to a luxurious, safe sanctuary and first class service that will enrich your experience.





Scenic Rail



South Korea and Japan have efficient, state-of-the-art rail systems. Our itineraries allow you to enjoy both the high-speed KTX trains in South Korea and Japan's world-renowned Shinkansen bullet trains.

The high-speed KTX trains and Shinkansen bullet trains offer several advantages over air travel, including more leg room than most economy flights – especially when considering your Green Class (Business) seats in Japan and First Class seats in South Korea.

Besides enjoying a smooth ride, you'll also get the opportunity to marvel at the wondrous scenery passing by, all the while barely conscious of the fact that you're moving so fast. A truly unique way to experience Japan and South Korea's way of life.

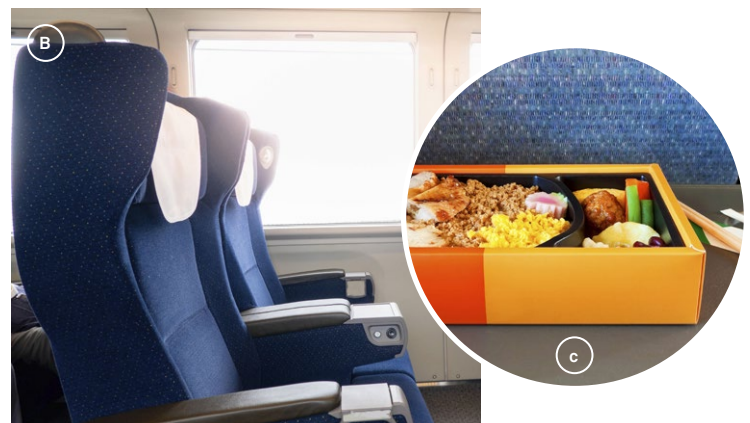

- A KTX train, South Korea
- B Shinkansen Green Class (Business Class)
- C Bento on board a Shinkansen bullet train
- D Shinkansen bullet train, Mount Fuji, Japan

CLICK HERE for the latest offers and up to date availability, or contact your local Travel Agent



Scenic

Travel Tailored to You

Seamless travel is integral, and it all begins before you even reach your destination. We've made getting there, and travelling home, both pleasurable and convenient by including flights from a selection of UK airports[‡]. You'll arrive feeling relaxed, refreshed and ready for your journey of a lifetime, thanks to our tailored travel arrangements.

A Economy flights

B Departures from a choice of regional airports[‡]

Designed for you

Our expert Journey Designers have meticulously considered each and every itinerary. This includes all pre-booked internal flights, as well as transfers from your arrival airport to the starting point of your journey. It's this level of consideration that comes as standard with Scenic and something you can expect throughout your time with us.

Upgrade your flight

Our brochure prices are based on Economy flights from London Heathrow[‡] but why not make your journey even more memorable by treating yourself to a flight upgrade? Premium Economy and business class flight upgrades are available on request at a supplement. Contact us today to find out more.

Fly locally

Thanks to our close partnerships with leading world-class airlines, you can fly from a choice of regional airports[‡]. Your chosen flight will connect with one of our handcrafted itineraries to ensure your journey is one of complete comfort, convenience and luxury from the beginning. To find the closest airport to suit all your travel plans, call our specialist team on **0808 258 3966**.



NB: Some flights may be indirect. [‡]Supplement's may apply if travelling on non-specific routes and regional departure airport.

To speak to our friendly and expert team call **0808 258 3966**



Hiroshima Peace Memorial, Japan
N 34° 23' E 132° 27'





○ JAPAN LAND JOURNEYS

For a land of modest size, Japan has more than its share of wondrous cities, imposing volcanic peaks, natural springs and beautiful temples, shrines and pagodas. Modern design and cutting-edge innovation are omnipresent, as are the echoes of the ancient Shinto codes that still influence the country. Here, creativity and discipline go hand in hand, with technology and traditional artistry combined to create a truly unique society.



Fushimi Inari Shrine, Kyoto, Japan
N34° 58' E135° 46'



Cultural Wonders

Discover centuries-old temples and captivating traditions. Visit the Hirosaki Castle, one of Japan's best blossom viewing locations, and Matsushima Bay, home to one of Tohoku's most famous Zen temples.



Scenic Enrich

Be immersed in Japan's history and culture through exclusive moments. Visit the home of sumo and watch their breathtaking training routines. Partake in a tea ceremony and learn to play the traditional Taiko drums.



Futuristic Cities

Explore Japan's futuristic side. Visit Tokyo and enjoy a walking tour of Dotonburi, Osaka's lively entertainment area famous for its flashy neon lights and booming restaurants and bars.



Iconic Hotels

Your hotels are selected on more than just reputation. It's a combination of best-in-class service, location and heritage, ensuring your stays are also an extraordinary immersive experience.

Discover Japan

From its ancient Samurai culture to present-day Japanese anime, the 'Land of the Rising Sun' has always had its own unmistakable identity. You'll find that same element of uniqueness in everything you come across in this proud and distinctive country, whether it's glittering skyscrapers or ancient temples, snow-capped peaks or state-of-the-art entertainment complexes.



[CLICK HERE](#) for the latest offers and up to date availability, or contact your local Travel Agent

- A Samurai
- B Osaka Castle
- C Shinjuku, Tokyo
- D Handcrafting sushi



The essence of modernity

Explore the bright lights of Fukuoka, Osaka and Tokyo – the world’s most populated city – and marvel at the innovative technologies that distinguish them and Japan’s other modern meccas. Stand in awe of magnificent skyscrapers, travel on bullet trains that are the envy of the world, visit factories that set global standards for innovation and productivity and retail precincts that offer every modern wonder imaginable.

A place with history and spirit

Discover a land where Samurais are still revered, from traditional corners to powerful corporations. Delight in the simplicity of beautiful temples and serene gardens. Encounter authentic geikos (geisha in Kyoto) and maikos (apprentice Geishas) and master the art of Taiko drumming, Sarubobo mascot making and handcrafting sushi. Learn about sumo wrestling and the Samurai tradition and be immersed in ancient culture as you visit centuries-old shrines. Japan is a land of spirituality and tradition, and you’ll have every opportunity to embrace it all.

📍 Japanese traditional dress



Traditionally, Japanese men and women wore the kimono, the style of which has changed little since the Edo period. Still worn on formal occasions and festivals, it is likely you will see both women and men wearing either formal (montsuki) or lightweight summer (yukata) kimono during your stay. Try wearing a kimono during your Scenic Enrich experience in Kyoto.



Japan in Focus

🕒 16 Day Land Journey 📍 Tokyo > Osaka

Something old, something new

Delight in the fascinating mystical wonders of Japan’s ancient customs and traditions.

Fall in love with the varied hues of Japan – from quirky Tokyo and Osaka to scenic Asuka. Experience a vivid contrast of neon city lights and bustling streets, including the ‘busiest intersection in the world’ in Tokyo. This compact journey enables the first-time traveller to experience the must-see and well-known aspects of Japanese culture, history and nature first hand. Immerse yourself in the life of a sumo wrestler at the Sumo Museum, as you learn the history of the sport and gain an insight into the life and training regime of a wrestler.



Sensoji temple, Tokyo, Japan

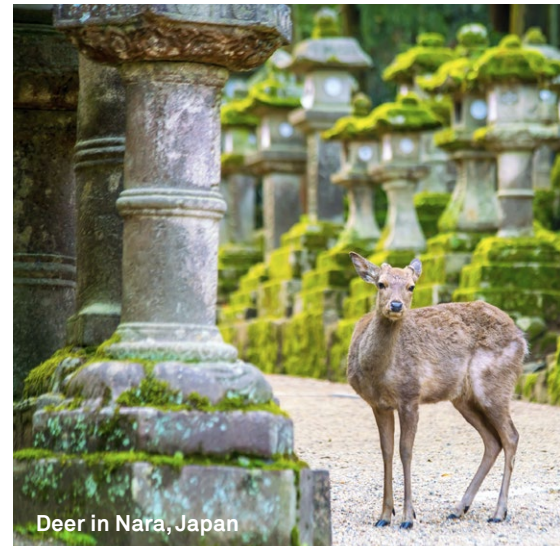

Deer in Nara, Japan



📍 Scenic Enrich

Learn about the history, life and training routine of a sumo wrestler during a private visit to a Sumo Museum in Kehayaza, where Sumo originated. After the welcome ceremony, see a demonstration of Jinku and the wrestlers in action in the dohyo.

To find out more about this itinerary [CLICK HERE](#)



The Scenic Difference:

- Personal origami crane offering in Peace Park Hiroshima
- Private sumo wrestler demonstration
- Private group dinner hosted by a geisha and maiko
- Partake in a Japanese tea ceremony whilst dressed in a kimono
- Dining options include a ninja-themed restaurant and the izakaya bar scene
- Stroll through the 300-year-old Korakuen Garden, one of the Three Great Gardens of Japan
- Play the Taiko drums in an interactive, private group demonstration and lesson
- Visit the Mazda Car Factory in Hiroshima

To speak to our friendly and expert team call 0808 258 3966

Japan in Focus

16 Day Itinerary Tokyo > Osaka

Day 1

UK > Tokyo

Fly to Tokyo from a choice of UK airports with selected airlines.

Day 2

Tokyo

Arrive in Tokyo and check into The Capitol Hotel Tokyo for a three-night stay.

Meals: D

Day 3

Tokyo 🌸🏯

Visit the Asakusa district, paying your respects at Sensoji temple.

Freechoice: Visit the Imperial Shinto Meiji Shrine, before walking across the busiest pedestrian crossing in the world in Shibuya. Alternatively, wander through picturesque Shinjuku-Gyoen Gardens before witnessing the Shinjuku entertainment district come alive at dusk.

Meals: B.L

Day 4

Tokyo 🌸🏯

Begin the day in the beautiful Imperial Palace's East Gardens, part of the inner palace area and the former site of Edo Castle's innermost circles of defence. Afterwards wander through Harajuku, the epicentre of Tokyo's teenage youth.

Enrich: *Given by Taiko Masters, partake in an interactive, private group demonstration and lesson in playing the Taiko drums.*

Freechoice Dining: Choose from dining at a ninja-themed restaurant or culturally immerse yourself in the traditional Japanese evening izakaya bar scene serving Yakitori and Kushiyaki.

Meals: B.L.D

Day 5

Tokyo > Five Lakes > Hakone 🌸🏯

Venture deep into the stunning scenery of the Kawaguchiko Area. Discover the incredible workmanship involved in creating kimonos at the Itchiku Kubota Art Museum. Near Hakone, cruise on Lake Ashinoko then take a cable car ride up the hot springs of the Owakudani geothermal area. Enjoy a Special Stay at Odakyu Hotel de Yama overlooking Lake Ashinoko.

Meals: B.L.D

Day 6

Hakone > Kyoto

Relax in your Green (Business) Class seats on the Shinkansen train to the culturally rich city of Kyoto. Visit Nijo Castle before settling into the Kyoto Brighton Hotel.

Meals: B.L.D

Day 7

Kyoto 🌸🏯

Begin the day at the famous Kinkaku-ji or Golden Pavilion. Afterwards, glide through the surreal Arashiyama Bamboo Grove by traditional rickshaw before exploring and enjoying a vegetarian meal at the World Heritage-listed Tenryu-ji Temple. This evening stroll through the Gion area before dinner.

Freechoice Dining: Enjoy the option of dining at Fortune Garden or try traditional Kaiseki at Gion Sekiya located in the famous Gion District.

Meals: B.L.D

Day 8

Kyoto 🌸🏯

Freechoice: Revel in the atmosphere of the ancient preservation districts or visit the Silver Pavilion before strolling along the famous Philosopher's Walk.

Enrich: *Partake in a Japanese tea ceremony while dressed in a traditional Japanese kimono, for a great photo opportunity.* This afternoon, enjoy some free time in Nishiki Market for shopping or relaxation.

Enrich: *Tonight's dinner will allow you to interact with a geiko and maiko who'll host your meal. It's an excellent opportunity to learn about what is involved in becoming a geisha and the art of Japanese hospitality.*

Meals: B.D

Day 9

Kyoto > Nara

Begin your day with an early visit to Fushimi Inari Shrine then continue to Nara, where you'll visit Todaiji Temple and see deer in Nara Park. Later, stop for a sake tasting at a sake museum.

Meals: B.L

⊕ Ryokan Upgrade

For a unique insight into Japanese culture, choose to stay tonight in a Ryokan (at additional cost, must be pre-booked before departure). This traditional Japanese Inn has tatami mat flooring with futon beds, sliding shoji paper doors, onsen hot spring baths and private facilities, and includes dinner and breakfast.

Day 10

Kyoto > Himeji > Okayama

Relax on the Shinkansen (bullet train) before marvelling at Himeji Castle, Japan's most spectacular original castle. Afterwards, move to Okayama to visit the 300-year-old Korakuen Garden, one of the Three Great Gardens of Japan. Continue to Kurashiki and check into the Ivy Square Hotel, or similar, for the night.

Meals: B.L.D



Taiko Drum Lesson, Tokyo

To find out more about this itinerary [CLICK HERE](#)

Essential Japan

🕒 20 Day Land Journey 📍 Tokyo > Osaka

The essence of Japan

This distillation of all things Japanese is designed to provide you with a truly unforgettable travel experience.

In the shadow of Mt Fuji, Hakone presents you with the opportunity to see the nearby Owakudani geysers and Hakone Open Air Museum. Partake in Japanese culture – try your hand at creating washi paper, copperware, your own chopsticks and origami. Dress in kimonos, dine with a geiko and maiko and play Taiko drums. From the large, neon-filled, modern cities of Tokyo and Osaka to the historic villages of Ichinomiya, Gokayama, Takayama and Tsumago Juku, you will see all aspects of Japanese culture and lifestyle during your journey.

Enjoy the very best the ‘Land of the Rising Sun’ has to offer, from feudal castles to traditional gardens, sporting traditions to tea ceremonies, from sake to sushi, and everything quintessentially Japanese in-between.



① Overnight --- Land ===== Rail



Tsumago Juku

Visit Tsumago Juku, a fully restored and preserved Edo era post town in the Kiso Valley. Sixty-nine post towns lined the Nakasendo route between Kyoto and Edo (modern Tokyo). Visit its restored principle inn, Honjin and Wakihonjin for the ‘lower-class’ travellers.



Main gate, Fushimi Inari-taisha, Kyoto



Shogawa Gorge

To find out more about this itinerary [CLICK HERE](#)



Takayama old quarter

The Scenic Difference:

- o Create your own souvenirs at a traditional copper, tin, goldcraft and washi paper making workshop
- o A personal origami crane donation at Hiroshima Peace Park
- o Private sumo wrestler demonstration
- o Private group dinner hosted by a geisha and maiko
- o Visit Asuka – the cradle of Japanese civilisation
- o Partake in a Japanese tea ceremony while dressed in a kimono
- o Play the Taiko drums in an interactive, private group demonstration and lesson
- o Visit Inuyama and Himeji castles, two of the five castles designated as national treasures
- o Visit the Mazda car factory in Hiroshima

To speak to our friendly and expert team call 0808 258 3966

Essential Japan

20 Day Itinerary Tokyo > Osaka

Day 1

UK > Tokyo

Fly to Tokyo from a choice of UK airports with selected airlines.

Day 2

Tokyo

Welcome to Tokyo. This evening, meet for your welcome reception and dinner at The Capitol Hotel Tokyu, your home for the next three nights.

Meals: D

Day 3

Tokyo

Visit the Asakusa district, paying your respects at Sensoji, the city's oldest Buddhist temple.

Freechoice: Visit the Imperial Shinto Meiji Shrine, before walking across the busiest pedestrian crossing in the world in Shibuya. Alternatively, wander through picturesque Shinjuku-Gyoen Gardens before witnessing the Shinjuku entertainment district come alive at dusk.

Meals: B.L

Day 4

Tokyo

Begin the day in the beautiful Imperial Palace's East Gardens, part of the inner palace area. Afterwards wander through Harajuku, the epicentre of Tokyo's teenage youth.

Enrich: *Given by Taiko Masters, partake in an interactive, private group demonstration and lesson in playing the Taiko drums.*

Freechoice Dining: Choose from dining at a ninja-themed restaurant or culturally immerse yourself in the traditional Japanese evening izakaya bar scene serving Yakitori and Kushiyaki.

Meals: B.L.D

Day 5

Tokyo > Five Lakes

Get to know Tokyo from above as you take in the view from

Tokyo Sky Tree. Then dress up in your chefs' clothes to make your own sushi lunch with the help of a local chef. Venture into the countryside on your drive to the Fuji Five Lakes district, known locally as Fujigoko. Later, discover the craftsmanship involved in creating kimonos at the Itchiku Kubota Art Museum, and soak in the views of Mt Fuji from your hotel, the Fuji Marriott Hotel Lake Yamanaka.

Meals: B.L.D

Day 6

Five Lakes > Hakone

Drive to Hakone and study the art works and sculptures at the Hakone Open Air Museum. Cruise on Lake Ashinoko before taking a cable car ride to up the hot springs of the Owakudani geothermal area. Enjoy a Special Stay at Odakyu Hotel de Yama, overlooking Lake Ashinoko.

Meals: B.L.D

Day 7

Hakone > Ichinomiya

Via Shinkansen in your Travel to Nagoya by Shinkansen in Green (Business) Class, then drive to the historic castle town of Ichinomiya. Learn about the ancient history of the area with a visit to the Shiro-to-Machi Museum before walking through the old town's streets to Inuyama Castle, the oldest of just five castles nationwide designated as national treasures. Afterwards, check into the IHG boutique hotel, Hotel Indigo Inuyama Urakuen Garden for the night.

Meals: B.L.D

Day 8

Ichinomiya > Tsumago Juku > Takayama

Head north to Takayama via Tsumago Juku, a fully restored and preserved

Edo Period post town in the Kiso Valley. Upon arrival in Takayama, enjoy a sake tasting and museum experience at Watanabe Sake House. Enjoy a two-night stay at the Hotel Associa Takayama Resort overlooking Takayama.

Freechoice Dining: Choose between Sakana Irori, a restaurant located in town known for its Hida Beef, or Sakanaya, a fine Japanese restaurant set in a renovated sake brewery.

Meals: B.L.D

Day 9

Takayama > Ainokura Village

View the impressive Yatai festival floats before driving to the historical farmhouses of the less visited mountain villages in Gokayama, a World Heritage-listed Site. Whilst here, try your hand at a washi paper-making workshop. Back in Takayama, explore the shops and backstreets of the old quarter, before a free evening to enjoy the area at your leisure.

Meals: B.L

Day 10

Takayama > Takaoka > Kanazawa

Head further north to Takaoka on a cruise through Shogawa Gorge with its stunning scenery. Takaoka is known for its copper and tinware so you will have the opportunity to create your own souvenir at one of the local workshops. Later, visit Zuiryuji Temple, a Soto Zen Buddhist temple and a national treasure completed circa 1659. Continue to Kanazawa and relax at the newly opened Hyatt Centric Kanazawa for the next two nights.

Meals: B.L.D

Day 11

Kanazawa

Wander around Kenroku-en Garden, one of Japan's three

great gardens located across from Kanazawa Castle Park. Move to the Higashi-Cgaya District and try your hand at making your own chopsticks at the Kanazawa Gold Leaf craft shop. Later, catch a glimpse of life in feudal Japan with a visit to former Kaga Clan Samurai houses in the Nagamachi district.

Meals: B.L

Ryokan Upgrade

For a unique insight into Japanese culture, choose to stay tonight in a Ryokan (at additional cost, must be pre-booked before departure). This traditional Japanese Inn has tatami mat flooring with futon beds, sliding shoji paper doors, onsen hot spring baths and private facilities, and includes breakfast and dinner.

Day 12

Kanazawa > Kyoto

Relax on the 'Thunderbird' train to the culturally rich city of Kyoto, home to many World Heritage-listed sites. Upon arrival, glide through the surreal Arashiyama Bamboo Grove by traditional rickshaw before exploring and enjoying a vegetarian meal at the World Heritage listed Tenryu-ji Temple. Afterwards visit the famous Kinkaku-ji or Golden Pavilion before settling into the Kyoto Brighton Hotel. Tonight, gather for a teppanyaki feast.

Meals: B.L.D

Day 13

Kyoto

Freechoice: Revel in the atmosphere of the ancient preservation districts or visit the Silver Pavilion before strolling along the famous Philosopher's Walk.

Enrich: *Partake in a Japanese tea ceremony while dressed in a traditional Japanese kimono, for a great photo opportunity.*

To find out more about this itinerary [CLICK HERE](#)



Asuka rice paddy fields

This afternoon, enjoy some free time in Nishiki Market. Later this evening, stroll through the Gion area before dinner.

Enrich: *Tonight's dinner will allow you to interact with a geiko and maiko who'll host your meal. It's an excellent opportunity to learn about what is involved in becoming a geisha and the art of Japanese hospitality.*

Meals: B.L.D

Day 14

Kyoto > Nara

Begin your day with an early visit to Nijo Castle before moving to the Fushimi Inari Shrine, featured in the movie *Memoirs of a Geisha*. Continue to Nara, where you'll visit Todaiji Temple and see deer in Nara Park, before spending a night at leisure at the new JW Marriott Hotel Nara.

Meals: B.L

Day 15

Nara > Himeji Castle > Hiroshima

Travel west via Shinkansen train to marvel at Himeji Castle, Japan's most spectacular original castle, before continuing to Hiroshima. Check into the new Hilton Hiroshima hotel for two nights. Tonight, sample Okonomiyaki, a delicious savoury Japanese-style pancake and specialty of the region.

Meals: B.L.D

Day 16

Hiroshima > Miyajima Island

Sail by ferry to Miyajima Island to visit the Daisho-in Temple and the floating Torii Gate at the Itsukushima Shrine.

Enrich: *Experience an emotional visit to the Peace Park and Museum before visiting Orizuru Tower to create your own special origami donation.*

Meals: B.L

Day 17

Hiroshima > Osaka

Begin the day with a visit to the Mazda car factory to see the robots at work along the production line. This afternoon, travel by Shinkansen train back to Osaka to enjoy a two-night Special Stay in an Executive Room with full club lounge access at the Hilton Osaka Hotel. This evening, catch the Osaka Metro to wander around the lively entertainment area of Dotonbori and Hozenji Yokocho food alley.

Meals: B.L

Day 18

Osaka > Asuka

Drive to the cradle of Japanese culture in Asuka. Wander through the Inabuchi terraced rice paddy fields, the ancient Tobiishi stone bridge and visit Ishibutai Tumulus,

the largest known megalithic structure in Japan.

Enrich: *Learn about the history, life and training routine of a sumo wrestler during a private visit to a Sumo Museum in Kehayaza, where sumo originated. After the welcome ceremony, see a demonstration of Jinku and the wrestlers in action in the dohyo.*

Enjoy your Club Floor benefits before reliving your experiences at your farewell dinner.

Meals: B.L.D

Day 19

Osaka

Bid a fond farewell to the 'Land of the Rising Sun' as you transfer to the airport for your overnight flight to the UK.

Meals: B

Day 20

Arrive UK

Welcome home.

5-star luxury inclusions:

- Return flights from a selection of UK airports
- Fully escorted small group land journey
- 5 exclusive Scenic Enrich experiences
- Your choice of 8 Scenic Freechoice activities and dining
- 2 memorable Scenic Special Stays
- 44 meals – 17 breakfasts (B), 16 lunches (L) and 11 dinners (D)
- Expert Tour Director
- All internal transport
- Return airport transfers

Departure Dates			Journey Code: DJPS		
2023	Twin share	Single	2024	Twin share	Single
Jun 15 [^]	£12,295	£14,770	Feb 24	£13,625	£16,170
Sep 25 [^]	£12,695	£15,205	Mar 16	£14,215	£17,345
Oct 16 [^]	£12,995	£16,025	Apr 13	£14,215	£17,345
			May 09	£13,825	£16,480
			Oct 26	£13,825	£16,480

 Departures may feature fall colours Departures may feature cherry blossoms

Terms and Conditions: All prices per person in GBP. Deposit is £1,250 per person. Flights are in Economy class. Airline availability dependent on date selected. Full payment is required 120 days prior to departure. Itinerary and departure date are subject to change. Prices are correct as of 19/12/22, please note a fuel surcharge may be applicable at time of full payment. ^{*}Itinerary operates in reverse. For full terms and conditions please refer to pages 66 to 69.

To speak to our friendly and expert team call 0808 258 3966



Mount Fuji, Japan
N 35° 21' E 138° 43'





Japan Unveiled

🕒 17 Day Land Journey 📍 Fukuoka > Tokyo **NEW**

The lesser-known side of Japan

Is there anything as dazzling as the lights of downtown Tokyo, or as jaw-dropping as your first sighting of Mt Fuji? Is there anything as moving as a visit to the Hiroshima Peace Memorial Museum? Or as elegant as getting up-close to a geisha in full traditional dress?

Discover ancient history, tradition and religion as they exist side by side with the industrial might and unique cultural quirks that characterise modern Japan. Visit the cradle of Japanese civilisation, Zen temples, traditional villages, extraordinary shrines, historical monuments and glorious gardens and landscapes.

Starting in the southern island of Kyushu in Fukuoka, travel along Honshu Island to Tokyo, visiting the many World Heritage-listed sites in Kyoto and the beauty of Mt. Fuji and the great lakes that surround it en route. You'll wonder just why you took so long to undertake such a wondrous journey.

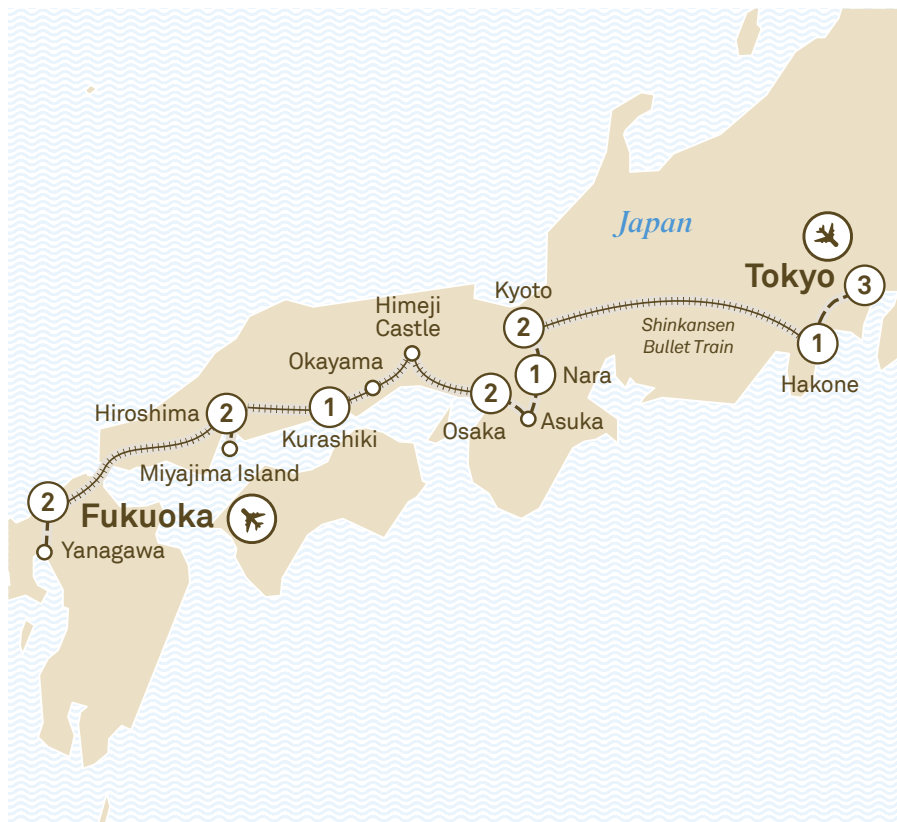

① Overnight --- Land ##### Rail



📍 Scenic Enrich

Learn about the history and story behind the making of origami cranes at Hiroshima Peace Park and the Atomic Museum before creating your own donation at the Orizuru Tower overlooking the Atomic Dome.



Miyajima

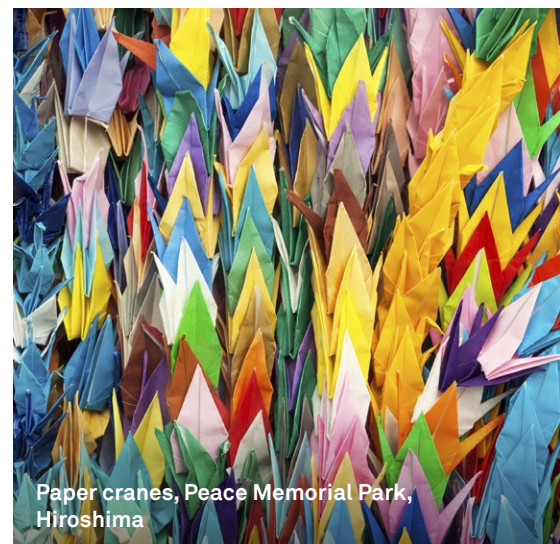

Paper cranes, Peace Memorial Park, Hiroshima

To find out more about this itinerary [CLICK HERE](#)



Japanese tea ceremony

The Scenic Difference:

- o A personal origami crane donation at Hiroshima Peace Park
- o Private sumo wrestler demonstration
- o Private group dinner hosted by a geisha and maiko
- o Visit Asuka – the cradle of Japanese civilisation
- o Partake in a Japanese tea ceremony while dressed in a kimono
- o Visit the 300-year-old Korakuen Garden, one of the Three Great Gardens of Japan
- o Visit the Mazda car factory in Hiroshima
- o Cruise on a yakatabune, an old-fashioned houseboat

To speak to our friendly and expert team call 0808 258 3966

Japan Unveiled

17 Day Itinerary Fukuoka > Tokyo

Day 1

UK > Fukuoka

Start your cultural adventure by flying overnight to Fukuoka from a choice of UK airports with selected airlines.

Day 2

Fukuoka

Enjoy your welcome reception at the Grand Hyatt Fukuoka, your luxury hotel for the next two nights.

Meals: D

Day 3

Fukuoka > Yanagawa

Drive to Yanagawa, dubbed the 'Venice of Kyushu' for a cruise along its canals, viewing the old town's culture and history. Stop at Yanagawa Ohana, the villa of the Tachibana family, who ruled Yanagawa from roughly 1600-1868. Return to Fukuoka for lunch.

Freechoice: Enjoy a self-guided bike ride around Uminonakamichi Seaside Park or visit Fukuoka Tower and Fukuoka castle ruins in Maizuru Park. This evening, head down to Fukuoka's open air food stalls (Yatai) to choose your own meal of yakitori, oden or hakata ramen.

Meals: B.L

Day 4

Fukuoka > Hiroshima

Travel by Shinkansen train to Hiroshima and head to the Mazda car factory to see the robots at work along the production line. After, check into the new Hilton Hiroshima hotel for two nights. Tonight, sample Okonomiyaki, a delicious savoury Japanese-style pancake and specialty of the region.

Meals: B.L.D

Day 5

Hiroshima > Miyajima Island

Sail by ferry to Miyajima Island to visit the Daisho-in Temple and the floating Torii Gate at the Itsukushima Shrine.

Enrich: Experience an emotional visit to the Peace Park and Museum before visiting Orizuru Tower to create your own special origami donation.

Meals: B.L

Day 6

Hiroshima > Okayama > Kurashiki

Travel by Shinkansen train to Okayama to visit the 300-year-old Korakuen Garden, one of the Three Great Gardens of Japan. Continue to Kurashiki, walk around the canal area and visit Ohashi House, a former Edo Period merchant house built in 1796. Check into the Ivy Square Hotel or similar for the night.

Meals: B.L.D

Day 7

Okayama > Osaka

En-route to Osaka on the Shinkansen train, stop at Himeji Castle and marvel at one of Japan's most spectacular remaining original feudal castles. This evening, admire the 360-degree view of Osaka from the Floating Garden Observatory, 170m off the ground. Then settle in for a two-night Special Stay in an Executive Room with full club access at the Hilton Osaka Hotel.

Meals: B.L.D

Day 8

Osaka

Freechoice: Wander through Shinsaibashi-suji shopping avenue, followed by Kuromon Ichiba Market, known as Osaka's kitchen, or visit the Museum of History and the rebuilt Osaka Castle.

Enjoy your Club Floor benefits before catching the Osaka Metro to wander around the lively entertainment area of Dotonbori and Hozenji Yokocho food alley.

Meals: B.L

Day 9

Osaka > Asuka > Nara

Drive to the cradle of Japanese culture in Asuka. Wander through the Inabuchi terraced rice paddy fields, the ancient Tobiishi stone bridge and visit Ishibutai tumulus, the largest known megalithic structure in Japan.

Enrich: Learn about the history, life and training routine of a sumo wrestler during a private visit to a Sumo Museum in Kehayaza, where sumo originated. After your welcome ceremony, see a demonstration of Jinku and the wrestlers in action in the dohyo.

Continue to Nara, where you will stop for a sake tasting at a sake museum before spending a night at the new JW Marriott Hotel Nara.

Meals: B.L.D

Day 10

Nara > Kyoto

This morning, visit Todaiji Temple and see deer in Nara Park, before stopping at Fushimi Inari Shrine, featured in the movie Memoirs of a Geisha. Continue to Kyoto, home to many World Heritage-listed sites.

Enrich: Partake in a Japanese tea ceremony while dressed in a traditional Japanese kimono, for a great photo opportunity.

Begin a memorable two-night stay at Kyoto Brighton Hotel with a teppanyaki dinner.

Meals: B.L.D

Day 11

Kyoto

Freechoice: Revel in the atmosphere of the ancient preservation districts or visit the Silver Pavilion and then stroll along the Philosopher's Walk. After, glide through the surreal Arashiyama Bamboo Grove by traditional rickshaw before exploring and enjoying a vegetarian meal at the World Heritage-listed Tenryu-ji Temple. Afterwards, visit the famous Kinkaku-ji or Golden Pavilion.

Enrich: Tonight's dinner will allow you to interact with a geiko and maiko who'll host your meal. It's an excellent opportunity to learn about what is involved in becoming a geisha and the art of Japanese hospitality.

Meals: B.L.D

Day 12

Kyoto > Hakone

Travel by Shinkansen train to Hakone. Admire the stunning views of Mt Fuji during your Lake Ashinoko cruise. Enjoy a Special Stay at Odakyu Hotel de Yama overlooking Lake Ashinoko.

Meals: B.L.D

Day 13

Hakone > Tokyo

En route to Tokyo, stop and study the art work and sculptures at the Hakone Open Air Museum. Upon arrival in Tokyo, visit the Asakusa district, paying your respects at Sensoji, the city's oldest Buddhist temple. Later, relax at The Capitol Hotel Tokyo, your home for the next three nights.

Freechoice Dining: Choose from dining at a ninja-themed restaurant or culturally immerse yourself in the traditional Japanese izakaya bar scene serving yakitori and kushiyaki.

Meals: B.L.D

To find out more about this itinerary [CLICK HERE](#)



Fukuoka

Day 14
Tokyo 🌸

Get to know Tokyo from above as you take in the view from Tokyo Sky Tree. Then dress up in your chefs' clothes to make your own sushi lunch with the help of a local chef.

Freechoice: Visit the Imperial Shinto Meiji Shrine, before walking across the busiest pedestrian crossing in the world in Shibuya. Alternatively, wander through picturesque Shinjuku-Gyoen Gardens before witnessing the Shinjuku entertainment district come alive at dusk.

Meals: B.L

Day 15
Tokyo

Begin the day in the beautiful Imperial Palace's East Gardens, part of the inner palace area.



Kuromon Ichiba Market, Osaka

Enjoy your afternoon at leisure for some last minute shopping in Shibuya. Later, take in the bright lights of Tokyo during your evening farewell dinner cruise on Tokyo Bay. Enjoy free-flowing drinks on a yakatabune, an old-fashioned houseboat.

Meals: B.L.D

Day 16
Tokyo

Say goodbye to the 'Land of the Rising Sun' with many wonderful memories. Transfer to the airport for your overnight flight to the UK.

Meals: B

Day 17
Arrive UK

Welcome home.



Yanagawa

5-star luxury inclusions:

- Return flights from a selection of UK airports
- Fully escorted small group land journey
- 4 exclusive Scenic Enrich experiences 🌟
- Your choice of 10 Scenic Freechoice activities and dining 🌸
- 2 memorable Scenic Special Stays 🏠
- 37 meals – 14 breakfasts (B), 13 lunches (L) and 10 dinners (D)
- Expert Tour Director
- All internal transport
- Return airport transfers

Departure Dates

Journey Code: DJFT

2023		Twin share	Single	2024		Twin share	Single
Oct	17	£13,080	£15,855	Mar	12	£13,080	£15,855
					Mar	26	£12,715 £15,145
					May	21	£13,440 £16,505
					Oct	08	£13,080 £15,855
					Oct	29	£13,025 £15,800

Departures may feature fall colours Departures may feature cherry blossoms

Terms and Conditions: All prices per person in GBP. Deposit is £1,250 per person. Flights are in Economy class. Airline availability dependent on date selected. Full payment is required 120 days prior to departure. Itinerary and departure date are subject to change. Prices are correct as of 19/12/22, please note a fuel surcharge may be applicable at time of full payment. For full terms and conditions please refer to pages 66 to 69.

To speak to our friendly and expert team call 0808 258 3966

Hidden Wonders of North Japan

🕒 16 Day Land Journey 📍 Tokyo > Sapporo

To the north of Tokyo lies many hidden treasures beyond the popular ski fields

Often overlooked for the more familiar golden triangle of Tokyo, Kyoto and Osaka, travelling north from Tokyo to Sapporo will reveal many natural and man-made treasures just waiting to be discovered.

Explore the natural treasures of North Honshu, such as the caldera-created Lake Towoda and Oirase Stream, Bandai-Asahi National Park, Genbikei Gorge and Matsushima Bay – for centuries considered one of Japan’s three most scenic views. Relish the full Japanese cultural experience of staying in an onsen in Hanamaki and try a variety of hands-on crafts to bring home as mementos. Discover the breadth of Japanese history, from old postal towns with Samurai warlords, mansions and Edo Castles, to ancient Jomon archaeological sites and thousands-of-years-old temples, rivalling those of Kyoto. Whether your fancy is tasting chocolate or famous Japanese beer, steak or seafood, this itinerary has it all, either as a first-time traveller or return visitor.



Hirosaki Castle



Sannai-Maruyama Archaeological Site



📍 Scenic Enrich

Transform Oirase’s natural beauty into a working lamp to bring home. At the Oirase Stream Museum, use your creative skills and imagination to create your own Mossball Lamp, a craft specialty of the region. Using a moss gour grown in the waters of the Oirase River as the lampshade, use your own design to hand create the lamp’s light pattern.

To find out more about this itinerary [CLICK HERE](#)



Japanese tea

The Scenic Difference:

- Play the Taiko drums in an interactive, private group demonstration and lesson
- Paint your own Sendai wooden kokeshi doll
- Experience Japanese onsen culture in Hanamaki
- Cruise Matsushima Bay, celebrated as one of Japan's three most scenic views
- Visit Hirosaki castle and park, one of Japan's best cherry blossom spots
- Cruise on Lake Towoda, walk along Oirase Stream
- Visit the Sannai-Maruyama Archaeological Site
- Try glass etching in Otaru's famous workshops
- Visit the Edo postal town of Uchi-juku and Samurai Mansion

To speak to our friendly and expert team call 0808 258 3966

Hidden Wonders of North Japan

16 Day Itinerary Tokyo > Sapporo

Day 1

UK > Tokyo

Fly to Tokyo from a choice of UK airports with selected airlines.

Day 2

Tokyo

Arrive in Tokyo, capital of Japan and transfer to The Capitol Hotel Tokyu, your home for the next two nights.

Meals: D

Day 3

Tokyo

Get to know Tokyo from above as you take in the view from Tokyo Sky Tree. Afterwards, wander through Harajuki, the epicentre of Tokyo's teenage youth.

Enrich: *Given by Taiko Masters, partake in an interactive, private group demonstration and lesson in playing the Taiko drums.*

Freechoice Dining: Choose from dining at a ninja-themed restaurant or culturally immerse yourself in the traditional Japanese izakaya bar scene serving yakitori and kushiyaki.

Meals: B.L.D

Day 4

Tokyo > Ouchi-juku > Lake Hibara

Begin the day with your first Shinkansen train journey to Koriyama, before driving to the preserved Edo postal town of Ouchi-juku. Try the local delicacy of soba noodles for lunch and explore the restored buildings. Learn all about brewing of sake at the Suehiro Brewery before moving to the picturesque Urabandai Lake Resort Nekoma Rikyu for the night, located within Bandai-Asahi National Park.

Meals: B.L.D

Day 5

Lake Hibara > Sendai

Step back in time when visiting the rebuilt Aizu

Bukeyashiki Samurai Mansion, originally destroyed in the Boshin War in 1868. Enjoy a scenic drive to Sendai.

Freechoice: Learn all about the history of the Date Clan and the history of the area around Sendai at the Sendai City Museum. Alternatively, visit the Kirin Brewery to discover the special production methods and the secret behind the beer's premium flavour.

Meals: B.L.D

Day 6

Sendai > Matsushima

Today, take a short drive to Matsushima Bay, for centuries celebrated as one of Japan's three most scenic views.

Enrich: *Witness the creation of the wooden kokeshi doll, an item originally created and sold at hot spring resorts in northern Japan. Test your creativity and imagination and paint your own wooden kokeshi doll.*

Visit the Zuigangi Temple, one of Tohoku's most famous Zen temples, originally dating back to 828. Continue next door to the Entsuin Temple, built in 1647 as a mausoleum for Date Terumune's son. Following a quick lunch of local street food, board your boat for a cruise around the 200 small islands covered by pine trees in Matsushima Bay. Before returning to Sendai, enjoy Japanese tea and a traditional snack at the Kanrantai Tea House whilst overlooking the bay.

Meals: B.L

Day 7

Sendai > Nobiru > Hanamaki

Head north to Nobiru and visit the destroyed train station, now a Disaster Recovery Memorial Museum to the 2011 tsunami.

Continue on to the scenic Genbikei Gorge before arriving at Chusonji Temple, established in 850. Located within one of the original buildings is Konjikido, a hall completely covered in gold dating back to 1124. Tonight, enjoy a Special Stay at Hanamaki Onsen Kashoen and indulge yourself in the full onsen experience.

Meals: B.L.D

Optional Authentic Japanese Experience

For tonight's stay, enjoy a unique insight into Japanese culture. Choose your bedding, from either western or traditional Japanese inn style with a futon. All rooms have tatami mat flooring with a mix of Japanese/western style décor, a Japanese cypress bathtub and a provided Yukata, which can be worn to tonight's traditional Kaiseki dinner. Be sure to also try the onsen hot spring baths.

Day 8

Hanamaki > Towada City > Lake Towada

Drive to Towada City, past rustic hot springs and the volcanic landscapes of the Towada – Hachimantai National Park. Admire the street art during your walk along the main street to the Towada Art Centre, featuring works from artists both inside and outside of Japan, including Yoko Ono, Yoshitomo Nara, and Jeong-Hwa Choi. Enjoy the picturesque drive toward Lake Towada and your two-night Special Stay at Hoshino Resorts Oirase Keiryu Hotel. The hotel is located on the Oirase Keiryu mountain stream, one of the most scenic locations in Japan.

Meals: B.L.D

Day 9

Lake Towada

Enrich: *At the Oirase Stream Museum, using your creative skills create your own Mossball Lamp, a specialty craft of the region.*

Afterwards, stretch your legs on a pristine walk along Oirase stream via the Deai-bashi Bridge before transferring to Yasumiya, a small town located on the lake shoreline. This afternoon, enjoy a relaxing cruise on Lake Towada, the largest caldera lake on Honshu, particularly known for its autumn foliage.

Meals: B.L.D

Day 10

Lake Towada > Hirosaki > Aomori

One of the most beautiful locations in Japan for sakura viewing is Hirosaki Castle and botanical gardens. Known for its five original turreted gates and fortified moats, this castle ranks as one of the country's most beautiful feudal era castles. Continue onto Aomori, the capital of the Aomori prefecture. Here, view amazing giant papier-mâché doll floats used in the Aomori Nebuta Festival at Rasser Land, located along the waterfront. Stay the night at the Hotel Aomori.

Freechoice Dining: If you're a keen carnivore, this is the restaurant for you, visit Tonkatsu Aki whose signature dish is crumbed port cutlets. Alternatively dine at one of Aomori's local izakaya restaurants.

Meals: B.L.D

Day 11

Aomori > Hakodate

Travel back in time to learn about the original inhabitants of the area at the Jomon Museum and Sannai-Maruyama Archaeological Site. With the site dating back to the late early to middle Jomon

To find out more about this itinerary [CLICK HERE](#)



Ouchi-juku

period, some 5500-4000 years ago, it shows the Jomon were the first people in the world to create pottery. Return to Aomori and travel by Shinkansen train through the undersea Seikan Tunnel to Hakodate on Hokkaido Island. Walk through the Motomachi Neighbourhood, an area full of historical buildings, before checking into Bourou Noguchi Hakodate.

Freechoice: At the traditional styled Hiten restaurant at Bourou Noguchi Hakodate, you can choose between Japanese-Western Kaiseki cuisine comprising a variety of fresh ingredients from the Hokkaido and Aomori prefectures or try Mediterranean-influenced Western-style cuisine, focused on seafood from the Seikan region.

Meals: B.D

Day 12

Hakodate

Choose to begin the day with an early morning visit to the fish market and try to catch some fresh squid for breakfast. Later, visit the 107m tall Goryoki Tower to get a bird's-eye view of Mt. Hakodate, Tsugaru Strait and the Yokotsu mountain range. Afterwards, walk through the Goryoki Park, located inside the old star-shaped fort adjoining the tower, and visit the old Hakodate Magistrate's Office within.

Spend the afternoon at leisure shopping around the historic Kanemori Red Brick Warehouse before meeting again to travel up the Mt. Hakodate Ropeway at dusk to see the amazing view over the city. Enjoy dinner tonight in one of Hakodate's beer halls.

Meals: B.D

Day 13

Hakodate > Sapporo

Travel by Super Hokuto Limited Express to Sapporo. Upon arrival, transfer to the Historic Village of Hokkaido, an open air museum which exhibits roughly 60 typical buildings from all over Hokkaido, dating from the Meiji and Taisho Periods (1868 to 1926). After checking into the Sapporo Grand hotel, your home for the next two nights, move to Ramen Yokocho in Susukino, a narrow lane lined with shops serving Sapporo's famous ramen.

Meals: B.D

Day 14

Sapporo > Otaru

Board a local train to Otaru and walk through Sakaimichi Street.

Enrich: *At one of Otaru's famous glassware workshops, who once produced glass buoys, try your hand at making a souvenir to bring home.*

Spend free time in the historic Otaru Canal area's museums, shops and restaurants before returning to Sapporo.

Freechoice: Indulge your sweet tooth at Shiroyo Koibito Park, which features a chocolate factory, shop and museum where you can get one of Sapporo's famous souvenirs, the Shiroyo Koibito cookie. Alternatively visit the Sapporo Beer Museum where you can learn about the history of the famous beer, taste one of the original brews and visit the attached beer halls and museum shop.

Afterwards, enjoy your farewell meal with your fellow travellers.

Meals: B.D

Day 15

Sapporo > UK

Bid a fond farewell to the 'land of the rising sun' as you transfer to the airport for your overnight flight to the UK.



Meals: B

Day 16

Arrive UK

Welcome home.

5-star luxury inclusions:

- Return flights from a selection of UK airports
- Fully escorted small group land journey
- 4 exclusive Scenic Enrich experiences 
- Your choice of 10 Scenic Freechoice activities and dining 
- 2 memorable Scenic Special Stays 
- 33 meals – 13 breakfasts (B), 8 lunches (L) and 12 dinners (D)
- Expert Tour Director
- All internal transport
- Return airport transfers

Departure Dates

Journey Code: DJTS

2023		Twin share	Single	2024	
Jun	07	£9,945	£11,620	Apr	09
Sep	06	£10,295	£12,250	Jun	04
Oct	04	£10,295	£12,250	Oct	22
Nov	01	£9,945	£11,620		

 Departures may feature fall colours  Departures may feature cherry blossoms

Terms and Conditions: All prices per person in GBP. Deposit is £1,250 per person. Flights are in Economy class. Airline availability dependent on date selected. Full payment is required 120 days prior to departure. Itinerary and departure date are subject to change. Prices are correct as of 19/12/22, please note a fuel surcharge may be applicable at time of full payment. For full terms and conditions please refer to pages 66 to 69.

To speak to our friendly and expert team call 0808 258 3966

○ SOUTH KOREA

Beyond its lively high-tech cities, South Korea fascinates with natural wonders such as impressive volcanic craters, picturesque waterfalls, ancient fortresses and even dinosaur fossils. As autumn turns the tree-lined boulevards into canary yellow dampung-gil (paths of autumn foliage) and spring brings pink cherry blossoms to life, this destination will surely be the scene for some of your most beautiful and fond travel memories.



Gayageum
(Korean string instrument)



Beautiful Paradoxes

Think ancient mystical temples and charming fishing villages in contrast with cities that never sleep and high-tech buildings. Everywhere you turn, South Korea offers new captivating discoveries.

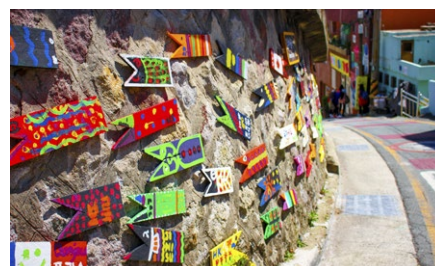

Cultural Hub

Visit Gamcheon Culture Village. Once a poor mountainside community, it's now an art hotspot. Wander through its streets and alleys to discover incredible art pieces, jaw-dropping views and colourful houses.



Enriching Experiences

Scenic Enrich moments will be the highlight of your journey. Enjoy hands-on experiences like crafting your own traditional musical instrument called the Gayageum.



Seamless Journey

When you travel with Scenic, everything is taken care of, from transfers and tipping to all transport – including experiences such as a ride on South Korea's state-of-the-art high-speed KTX rail system.



Discover South Korea

From one of the most heavily militarised borders in the world to designated 'slow cities', South Korea is a lovely surprise wrapped in culture, history and breathtaking natural beauty. It is even more captivating when presented by the welcoming locals.





With a neighbour that is closely guarded and shut off from the rest of the world, South Korea is the most delightful paradox in the Korean peninsula. Here, people shop till the early hours of the morning, lovers kiss under pink cherry blossoms, and heart-warming hospitality makes you feel right at home.

The cities combine tradition and modernity, while the countryside seems untouched by time. Picture a green, hilly countryside, sub-tropical islands, high-tech cities, delicious cuisine and a 5,000-year-old culture and you'll get why South Korea is such a memorable experience.

With a transport network that works with clockwork precision, shuffling between big city lights and rural tranquility is a breeze, which makes exploring the Land of the Morning Calm even more delightful.

The past

Over the years, the Korean peninsula has survived invasions by various forces, from the Manchus of East Asia in the 17th century to the Japanese in the 20th century. The hard-fought Korean War of

the 1950s has left tell-tale signs in the form of the demilitarised zone (DMZ) between North Korea and South Korea, the most heavily militarised border in the world.

The still present

Despite the bloody battle for its sovereignty, South Korea has safeguarded its centuries-old traditions and culture within the folds of everyday life. The eldest at the table always eats first, festivals are celebrated in the hanbok, skyscrapers share the horizon with hanoks and children learn to play the traditional gayageum.

The everlasting

While Seoul's 'Gangnam style' glitz has its own charm, South Korea's eternal beauty is found in its breathtaking natural wonders. The hush of soft snow descending on falling leaves, a gentle shower of pink cherry blossoms, the cooling shade of the lush green canopy and the rustling carpet of golden foliage - every season brings forth a new paradise.



- A Traditional Korean cuisine
- B Korean women in Hanbok, Seoul
- C The Demilitarised Zone (DMZ)
- D Cheomseongdae Observatory, Gyeongju
- E Gayageum, a traditional Korean string instrument

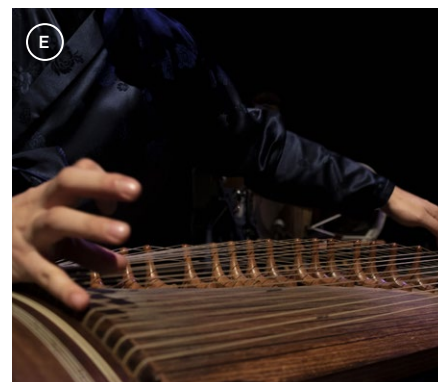

The Soul of South Korea

Changdeokgung Palace, Seoul

Exploring the land of contrasts

Discover a nation with one of the most heavily militarised borders in the world and one of the fastest growing economies in Asia – the land of serene ‘slow cities’, and canopies of pink blossoms.

On this compact journey of South Korea, learn about its people, cuisine, ancient history and culture and appreciate the modernisation strides this Asian tiger economy has taken. From the ancient villages around Gyeongju to modern Busan and the high-speed trains in between, come and explore this lesser-known Asian treasure.

 12 Day Land Journey  Seoul > Seoul

Day 1 UK > Seoul

Fly to Seoul from a choice of UK airports with selected airlines.

Day 2 Seoul

Welcome to South Korea. Upon arrival in Incheon, transfer to the Lotte Hotel for your three-night stay located near the Myeongdong area, residing in club floor rooms in the Executive Tower. Meet your Tour Director and fellow travellers at tonight's welcome briefing and dinner, comprising modern Korean cuisine.

Meals: D

Day 3 Seoul

Begin your exploration of Seoul with a visit to, arguably, the most beautiful of the five Grand Joseon Palaces, Changdeokgung Palace.

Dressed in Hanbok, Korean traditional costume, your visit to this World Heritage-listed palace would not be complete without a stroll through the Secret Garden contained within. This afternoon, witness the changing of the Royal Guard at Deoksugung Palace before moving to the Korean Furniture Museum, housing over 2,000 pieces of Joseon Dynasty furniture in 10 restored traditional Korean houses known as hanok. Tonight, enjoy a Korean specialty, Korean BBQ chicken and beer.

Meals: B.L.D

Day 4 Seoul > DMZ

Leave early this morning to drive to the Demilitarised Zone (DMZ) for a morning of exploration, and views of North Korea. Visit the Dora Observatory, Dorasan Station and Freedom Bridge and go underground by monorail to

the third infiltration Tunnel. Return to Seoul this afternoon and shop at the largest traditional market in South Korea, Namdaemun Market, located next to the Great South Gate of the original old city.

Enrich: Tonight, enjoy a private dinner with entertainment at a Hanok, dating back to the 14th century Joseon dynasty.

Meals: B.L.D

Day 5 Seoul > Gwangju

Relax in your Deluxe Class seats on the KTX high-speed train ride to Gwangju. Feel at peace on your walk through the Juknokwon bamboo forest before visiting Samjinae village to experience ‘slow living’ at the designated ‘Slow City’. Try your hand at making Hangwa, Korean traditional sweets before returning to Gwangju to check into the Holiday Inn for a night at leisure.

Meals: B.L

Day 6 Gwangju > Gyeongju

Begin your drive to Mt. Gayasan National Park. Visit the Haeinsa Temple, famous for being the home of the Tripitaka Koreana since 1398, a collection of 81,350 wooden printing blocks with the Buddhist scriptures carved on them.

Enrich: This afternoon at Gayatgo Village, enjoy a hands-on experience crafting your own mini Gayageum, a zither-like 12-string Korean musical instrument, and take it home as a keepsake. It is yours to take home as a keepsake. Continue onto Gyeongju, known as the ‘museum without walls’ and check into the Gyeongju Hilton Hotel for a two-night stay.

Meals: B.L.D

Day 7 Gyeongju

Visit the National Museum, home to relics from the Silla Kingdom when Gyeongju was the capital. View the Cheomseongdae Observatory, Tumuli Park, a collection of royal Silla tombs and Anapji Pond. Lunch is a hands-on cooking class of cuisine dating back to the Shilla Dynasty. Later, visit World Heritage-listed Bulguksa Temple and Seokguram Grotto.

Enrich: At the Bulguksa Temple in Gyeongju, witness a sublime performance of Seungmu, a Korean dance performed by Buddhist monks.

Meals: B.L

Day 8 Gyeongju > Busan

Begin your drive to Busan with a stop en route at Tongdosa, one of the most important temples in Korea and the head temple of the Jogye Order.

To find out more about this itinerary [CLICK HERE](#)

10 Day Itinerary Seoul > Seoul

① Overnight --- Land + Rail



Silla tombs, Tumuli Park, Gyeongju

Freechoice: Visit the Gamcheon Culture Village, once a modest mountainside community that has been transformed into an art hotspot, or ride the Danubi 'Train' around Taejongdae Park Rocky Cliff, famous for its seascapes. Alternatively, visit Haedong Yonggungsa Temple, a Buddhist temple built in 1376.

Check into Busan Paradise Hotel on the beachfront for a two-night stay.

Meals: B,L

Day 9

Busan > Jinhae

From Busan Tower, admire the views of the coastline and the port city before moving to Jagalchi Fish Market, the largest in South Korea. Next, visit BIFF Square and nearby Kukje Market, known for its Mokja Golmok – Let's Eat Alley. This afternoon, drive to Jinhae and visit Jinhae Dream Park with the famous Yeojwacheon Stream. Also visit the NFRDI Environment Eco-Park and Jangboksan Sculpture Park to see the red and orange foliage in autumn and delicate blossoms in spring.

Freechoice Dining: Enjoy fine Italian cuisine at the converted art gallery, Kitchen Dongbaek or sample high quality Korean sirloin BBQ at Daedo Korean restaurant.

Meals: B,D

Day 10

Busan > Seoul

Travel in your Deluxe Class seats on the KTX high-speed train to Seoul. Upon arrival, drive to the Gangnam District to have your photo taken in front of the Statue of Gangnam Style. Spend some free time at the COEX underground shopping mall, the largest in Asia. Later, check into the InterContinental Seoul COEX before savouring a sumptuous Korean Bulgogi BBQ feast at your farewell dinner.

Meals: B,D

Day 11

Seoul > UK

Say farewell to this intriguing land and transfer to Incheon airport for your return flight home.

Meals: B

Day 12

Arrive UK

Welcome home.



Scenic Enrich experience

At the Bulguksa Temple in Gyeongju, witness a sublime performance of Seungmu, a Korean dance performed by Buddhist monks. This Folk dance was designated as Korea's Important Intangible Cultural Asset No. 27 in 1968.

5-star luxury inclusions:

- Return flights from a selection of UK airports
- Fully escorted small group land journey
- 3 exclusive Scenic Enrich experiences
- Your choice of 5 Scenic Freechoice activities and dining
- 21 meals – 9 breakfasts (B), 6 lunches (L) and 6 dinners (D)
- Expert Tour Director and knowledgeable local guides
- All internal transport
- Return airport transfers

Departure Dates

Journey code: DSKS

2023 Departures		Twin share	Single	2024 Departures		Twin share	Single
Oct	03	£6,545	£7,510	Mar	19	£8,565	£10,545
Nov	14	£6,545	£7,510	Apr	02	£8,870	£10,855

Departures may feature fall colours Departures may feature cherry blossoms

Terms and Conditions: All prices per person in GBP. Deposit is £1,250 per person. Flights are in Economy class. Airline availability dependent on date selected. Full payment is required 120 days prior to departure. Itinerary and departure date are subject to change. Prices are correct as of 19/12/22, please note a fuel surcharge may be applicable at time of full payment. For full terms and conditions please refer to pages 66 to 69.

To speak to our friendly and expert team call 0808 258 3966

ULTIMATE JOURNEYS

Extend your East Asia discovery by combining a river cruise with one or more land journeys. This is the best way to create the Ultimate Journey to explore these diverse, enriching destinations.

You can add your Japan or South Korea land journey before or after your truly all-inclusive 5-star Mekong river cruise. Or, if you prefer to explore only by land, make it an immersive experience through South East Asia by combining our handcrafted Japan and South Korea itineraries.



Imperial Palace, Tokyo, Japan
N 35° 41' E 139° 45'



Multi-Destination

Extend your exploration with combined journeys across Japan, South Korea and beyond. From futuristic cities to temples and shrines, widen your discovery of these amazing Asian destinations.



Mekong River Cruise

Combine your Japan handcrafted land journey with our beloved luxury Mekong river cruise. Delight in the fascinating mystical wonders of these waterways as you explore the region's rich culture & history.



5-Star Scenic Spirit

With up to only 68 guests on board, it's more than a luxury river cruise; it's your sanctuary on the Mekong. Unpack just once and relax as the exotic landscapes float by.



Scenic Enrich

Enjoy a private sumo demonstration, create your own mini Gayatgo souvenir, and be awestruck at a mystical-themed Gala Dinner at an Angkor temple as some of your Scenic Enrich exclusive experiences.

Japan & South Korea in Focus

⌚ 25 Day Land Journey & Cruise 📍 Tokyo > Seoul

From Kimonos to Hanboks

From interacting with a real-life geisha to meeting an industrial robot, Japan is a delightful rollercoaster ride. While South Korea, with its heavily guarded DMZ and peaceful temple retreats, is a wondrous paradox.

Begin your exploration in the 'Land of the Rising Sun' by learning to play Taiko Drums, dining at a ninja-themed restaurant and washing it all down with sake. Dodge the crowds at the busiest intersection in the world and release an origami crane at Hiroshima Peace Park. As your journey carries you to South Korea, you will be amazed at the various intricacies that set it apart from its neighbours. On your journey through the fascinating land, you will ride its high-speed trains, admire the old-fashioned hanok houses, don the traditional Hanbok and experience the tranquillity of a slow city.



① Overnight - - - Land ▬▬▬ Rail ····· Included flight

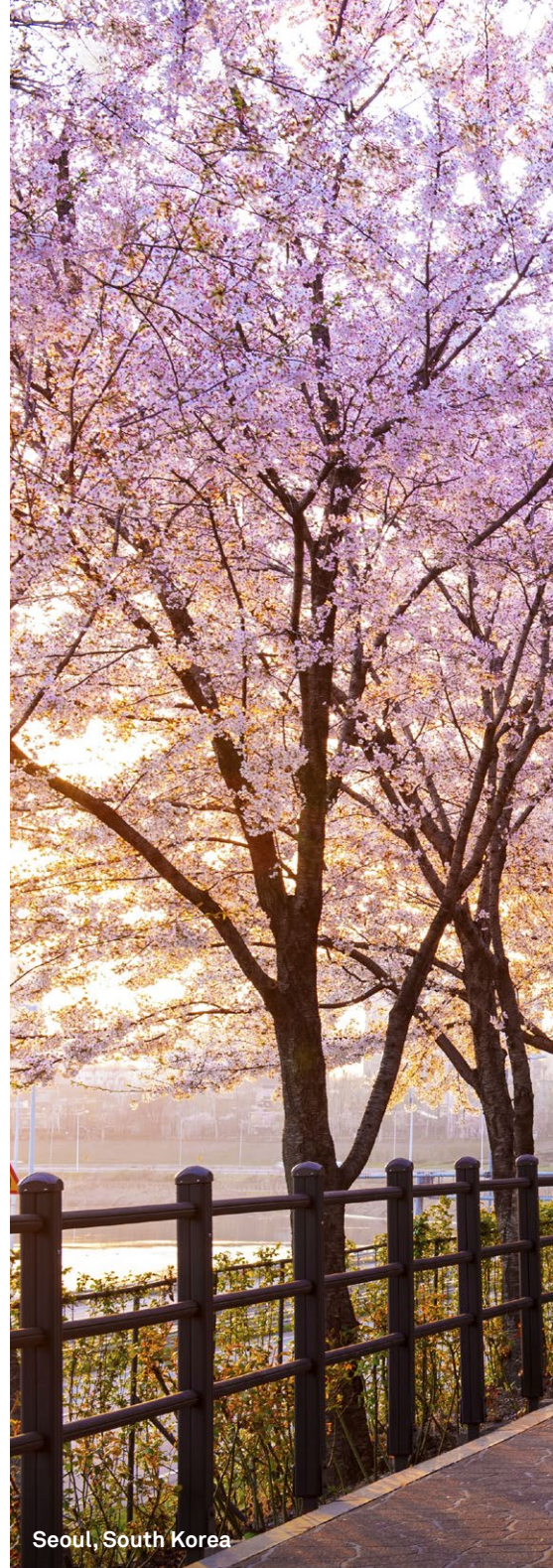

Seoul, South Korea



Gamcheon Culture Village, South Korea



📍 Scenic Enrich

In the rural recreation village of Gayatgo, enjoy a hands-on experience crafting your own mini Gayageum, a zither-like 12-string Korean musical instrument and symbol of the village. Fashioned from Paulownia wood, it has 12 silk strings and movable bridges on a convex upper surface. It will be yours to take home as a keepsake.

To find out more about this itinerary [CLICK HERE](#)



Miyajima, Japan

The Scenic Difference:

- View a private sumo wrestler demonstration in Kehayaza
- Private group dinner hosted by a geisha and maiko
- Stroll through the 300-year-old Korakuen Garden, one of the Three Great Gardens of Japan
- Play the Taiko drums in an interactive, private group demonstration and lesson
- Dress in Hanbok at Changdeokgung Palace
- Craft a mini Gayageum, a Korean musical instrument
- Make traditional Korean confectionery in Samjinæ village
- Visit Jinhae during the cherry blossom season

To speak to our friendly and expert team call 0808 258 3966

Japan & South Korea in Focus

25 Day Itinerary Tokyo > Seoul

Day 1

UK > Tokyo

Fly to Tokyo from a choice of UK airports with selected airlines.

Day 2

Tokyo

Arrive in Tokyo and transfer to The Capitol Hotel Tokyu, your home for the next three nights.

Meals: D

Day 3

Tokyo 🌸

Visit the Asakusa district and Sensoji temple.

Freechoice: Visit the Imperial Shinto Meiji Shrine, before walking across the famous pedestrian crossing in Shibuya. Alternatively, wander through Shinjuku-Gyoen Gardens.

Meals: B.L

Day 4

Tokyo 🍣 🌸

Begin the day in the Imperial Palace's East Gardens then make your own sushi lunch. Afterwards, wander through Harajuku.

Enrich: Partake in an interactive, private group demonstration and lesson in playing the Taiko drums.

Freechoice Dining: Choose from dining at a ninja-themed restaurant or traditional izakaya bars.

Meals: B.L.D

Day 5

Tokyo > Five Lakes > Hakone 🏯

Venture into the Kawaguchiko Area. Discover the workmanship in creating kimonos at the Itchiku Kubota Art Museum. Cruise on Lake Ashinoko, then take a cable car ride up to the hot springs of the Owakudani geothermal area. Enjoy a Special Stay at Odakyu Hotel de Yama.

Meals: B.L.D

Day 6

Hakone > Kyoto

Relax in your Green (Business) Class seats on the Shinkansen train to Kyoto. Visit Nijo Castle before settling in at the Kyoto Brighton Hotel.

Meals: B.L.D

Day 7

Kyoto 🌸

Begin the day at the famous Kinkaku-ji or Golden Pavilion. Afterwards, glide through the surreal Arashiyama Bamboo Grove by traditional rickshaw before exploring and enjoying a vegetarian meal at the World Heritage listed Tenryu-ji Temple. This evening, stroll through the Gion area.

Freechoice Dining: Enjoy the option of dining at Fortune Garden or try traditional Kaiseki at Gion Sekiya located in the famous Gion District.

Meals: B.L.D

Day 8

Kyoto 🌸 🍣

Freechoice: Revel in the atmosphere of the ancient preservation districts or visit the Silver Pavilion before strolling along the famous Philosopher's Walk.

Enrich: Partake in a Japanese tea ceremony while dressed in a traditional Japanese kimono, for a great photo opportunity.

This afternoon, enjoy some free time in Nishiki Market.

Enrich: Tonight's dinner will allow you to interact with a geiko and maiko who'll host your meal. It's an excellent opportunity to learn about what is involved in becoming a geisha and the art of Japanese hospitality.

Meals: B.D

Day 9

Kyoto > Nara

Begin your day with an early visit to Fushimi Inari Shrine then continue to Nara, where you'll visit Todaiji Temple and see deer in Nara

Park. Later, stop for a sake tasting at a sake museum.

Meals: B.L

⊕ Ryokan Upgrade

Choose to stay tonight in a Ryokan (at additional cost, must be pre-booked before departure).

Day 10

Kyoto > Himeji > Okayama

Relax on the Shinkansen before marvelling at Himeji Castle, one of Japan's most spectacular original castles. Afterwards, move to Okayama to visit the 300-year-old Korakuen Garden, one of the Three Great Gardens of Japan. Continue to Kurashiki and check into the Ivy Square Hotel or similar for the night.

Meals: B.L.D

Day 11

Kurashiki > Hiroshima

Walk around the Kurashiki canal area and visit Ohashi House, a former Edo Period merchant house. Travel on the Shinkansen to Hiroshima and check into the Hilton Hiroshima hotel for two nights. Tonight, sample Okonomiyaki, a delicious savoury Japanese-style pancake and specialty of the region.

Meals: B.L.D

Day 12

Hiroshima > Miyajima Island 🍣

Sail by ferry to Miyajima Island to visit the Daisho-in Temple and the floating Torii Gate at the Itsukushima Shrine.

Enrich: Experience an emotional visit to the Peace Park and Museum before visiting Orizuru Tower to create your own special origami crane offering.

Meals: B.L

Day 13

Hiroshima > Osaka 🏯

Begin the day with a visit to the Mazda car factory. This afternoon travel by Shinkansen back to Osaka to enjoy a two-night Special Stay in an Executive Room with full club lounge access at the Hilton Osaka Hotel. This evening, catch the Osaka Metro to wander around the lively entertainment area of Dotonbori and Hozenji Yokocho food alley.

Meals: B.L

Day 14

Osaka > Asuka 🍣

Drive to the cradle of Japanese culture in Asuka. Wander through the Inabuchi terraced rice paddy fields, the ancient Tobiishi stone bridge and visit Ishibutai Tumulus, the largest known megalithic structure in Japan.

Enrich: Learn about the history, life and training routine of a sumo wrestler during a private visit to a Sumo Museum in Kehayaza, where sumo originated.

Enjoy your Club Floor benefits before reliving your experiences at your Japanese farewell dinner.

Meals: B.L.D

Day 15

Osaka > Seoul

Bid farewell to Japan and transfer to Kansai airport for your flight to Seoul, South Korea. Upon arrival in Incheon, transfer to the Lotte Hotel for your three-night stay, and reside in club floor rooms in the Executive Tower. Meet your Korean Tour Director and fellow travellers at tonight's welcome briefing and dinner.

Meals: B.D

Day 16

Seoul

Visit Changdeokkung Palace, dressed in Hanbok, Korean traditional costume, including a stroll through



Himeji Castle, Japan

the Secret Garden. Witness the changing of the Royal Guard at Deoksugung Palace before moving to the Korean Furniture Museum. Tonight, enjoy a Korean specialty, Korean BBQ chicken and beer.

Meals: B.L.D

Day 17

Seoul > DMZ

Drive to the Demilitarised Zone (DMZ). Visit the Dora Observatory, Dorasan Station and Freedom Bridge and go underground to the third infiltration Tunnel. Return to Seoul and shop at Namdaemun Market.

Enrich: *Tonight, enjoy a private dinner with entertainment at a Hanok, a traditional Korean house dating back to the 14th century Joseon dynasty.*

Meals: B.L.D

Day 18

Seoul > Gwangju

Relax in your Deluxe Class seats on the KTX high-speed train ride to Gwangju. Walk through the Juknokwon bamboo forest before visiting Samjinae village, a designated 'Slow City'. Try your hand at making Korean traditional sweets before checking into the Holiday Inn for a night.

Meals: B.L

Day 19

Gwangju > Gyeongju

Drive to Mt. Gayasan National Park and Haeinsa Temple, famous for being the home of the Tripitaka Koreana.

Enrich: *At Gayatgo Village, enjoy a hands-on experience crafting your own mini Gayageum, a zither-like 12-string Korean musical instrument.*

Continue onto Gyeongju Hilton Hotel for a two-night stay.

Meals: B.L.D

Day 20

Gyeongju

Begin with a visit to the National Museum. Also view the Cheomseongdae Observatory, Tumuli Park, a collection of royal Silla tombs and Anapji Pond, a harmonious royal garden. Lunch is a hands-on cooking class. Afterwards, visit World Heritage-listed Bulguksa Temple and Seokguram Grotto.

Enrich: *At the Bulguksa Temple in Gyeongju, witness a sublime performance of Seungmu, a Korean dance performed by Buddhist monks.*

Meals: B.L

Day 21

Gyeongju > Busan

Drive to Busan with a stop en route at Tongdosa, the head temple of the Jogye Order.

Freechoice: Visit the Gamcheon Culture Village, or ride the Danubi 'Train' around Taejongdae Park. Alternatively, visit Haedong Yonggungsa Temple. Check into Busan Paradise Hotel for a two-night stay.

Meals: B.L

Day 22

Busan > Jinhae

Admire the views from Busan Tower before moving to Jagalchi Fish Market, then visit BIFF Square and nearby Kukje Market. This afternoon, drive to Jinhae Dream Park with its famous Yeojwacheon Stream.

Also visit the NFRDI Environment Eco-Park and Jangboksan Sculpture Park. **Freechoice Dining:** Enjoy fine Italian cuisine or sample high quality Korean sirloin BBQ.

Meals: B.D

Day 23

Busan > Seoul

Travel in your Deluxe Class seats on the KTX high-speed train to Seoul. Spend some

free time at the COEX underground shopping mall. Later, check into InterContinental Seoul COEX before a Korean Bulgogi BBQ feast at your farewell dinner.

Meals: B.D

Day 24

Seoul > UK

Say farewell and transfer to Incheon airport for your overnight flight to the UK.



Meals: B

Day 25

Arrive UK

Welcome home.

5-star luxury inclusions:

- Return flights from a selection of UK airports
- Fully escorted small group land journey
- 8 exclusive Scenic Enrich experiences 
- Your choice of 13 Scenic Freechoice activities and dining 
- 2 memorable Scenic Special Stays 
- 54 meals – 22 breakfasts (B), 17 lunches (L) and 15 dinners (D)
- Expert Tour Directors
- All internal transport
- Return airport transfers

Departure Dates

Journey code: DJSK

2023 Departures		Twin share	Single
Sep*	20	£15,705	£19,085
Nov	01	£16,055	£19,160

 Departures may feature fall colours  Departures may feature cherry blossoms

Terms and Conditions: All prices per person in GBP. Deposit is £1,250 per person. Flights are in Economy class. Airline availability dependent on date selected. Full payment is required 120 days prior to departure. Itinerary and departure date are subject to change. Prices are correct as of 19/12/22, please note a fuel surcharge may be applicable at time of full payment. *Itinerary operates in reverse. For full terms and conditions please refer to pages 66 to 69.

To speak to our friendly and expert team call 0808 258 3966

SOUTH EAST ASIA RIVER CRUISING

The Mekong River is at the heart of everyday life in Vietnam and Cambodia. One of the most biologically diverse rivers in the world, second only to the Amazon, this magical waterway will capture your sense of wonder. With up to only 68 guests on board, the Scenic Spirit experience is more than a 5-star river cruise. It's your sanctuary on the Mekong. Unpack just once and settle into your spacious suite. Explore, relax, indulge and dream, as the exotic landscapes float by.



Royal Panorama Suite

Located on the Diamond Deck, these suites offer the ultimate indulgence with a private terrace with outdoor Jacuzzi, separate lounge area and oversized bathroom with a bath.

Sun Deck

Take in the views from the Sun Deck bar and watch the ever-changing panoramas, while enjoying a drink from the bar or relaxing at the outdoor cinema.



Observation Lounge & Library

Sit back and relax with your favourite classic from our extensive, curated book collection.

Wellness Area

Delight in a Khmer massage, attend a morning yoga class or enjoy the services of the hair salon, sauna and steam room, and state-of-the-art gym.

Herb Garden

The secret to our delicious, fresh and flavourful on board cuisine.



Watch a guided walk-through of the luxurious Scenic Spirit [CLICK HERE](#)

Balcony Suites with Scenic Sun Lounges

With the largest lead-in suites on the Mekong, watch the world go by from your dining room, bedroom or Sun Lounge.



Spirit Lounge

Located at the heart of the ship, this is the perfect place to unwind with our international selection of wines, beers, spirits, cocktails and specialty teas and coffees, and reflect on your day.



Vitality Pool & Bar

Relax in the Vitality Pool or simply enjoy views with a drink at the bar.



Crystal Dining

Enjoy a delicious breakfast, lunch or dinner in our spacious restaurant with open seating. Enjoy fresh, homemade bread, yoghurt, jams and more each day.

River Café

Catch up with fellow guests for a casual meal or snack and relish a range of light refreshments while taking in the scenery.

Complimentary Wi-Fi

Share your Scenic wonder moments with your loved ones with complimentary on board Wi-Fi.



Luxury Mekong & Japan in Focus

⌚ 28 Day Land Journey & Cruise 📍 Siem Reap > Osaka

Something old, something new

Delight in the fascinating mystical wonders of the Mekong as you explore its centuries-old temples and partake in its ancient customs and traditions. Fall in love with the varied hues of Japan – from quirky Tokyo to scenic Asuka.

After an immersive spiritual sojourn along the magical Mekong, experience a vivid contrast of neon city lights and bustling streets, including the ‘busiest intersection in the world’ in Tokyo. Immerse yourself in the life of a sumo wrestler on a private visit to the Sumo Museum, as you learn about the history of the sport and the life of a training wrestler.



① Overnight — Alaskan cruise --- Land + Rail Flight not included Included flight

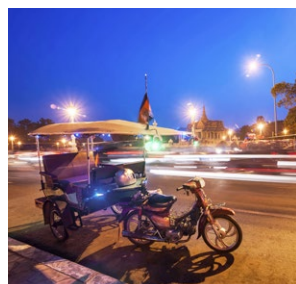

📍 Scenic Enrich

Revel in our Phnom Penh by City Lights tour, giving you an insight into the nightlife of the capital before stopping at a distillery for an exclusive tour and tasting behind closed doors.

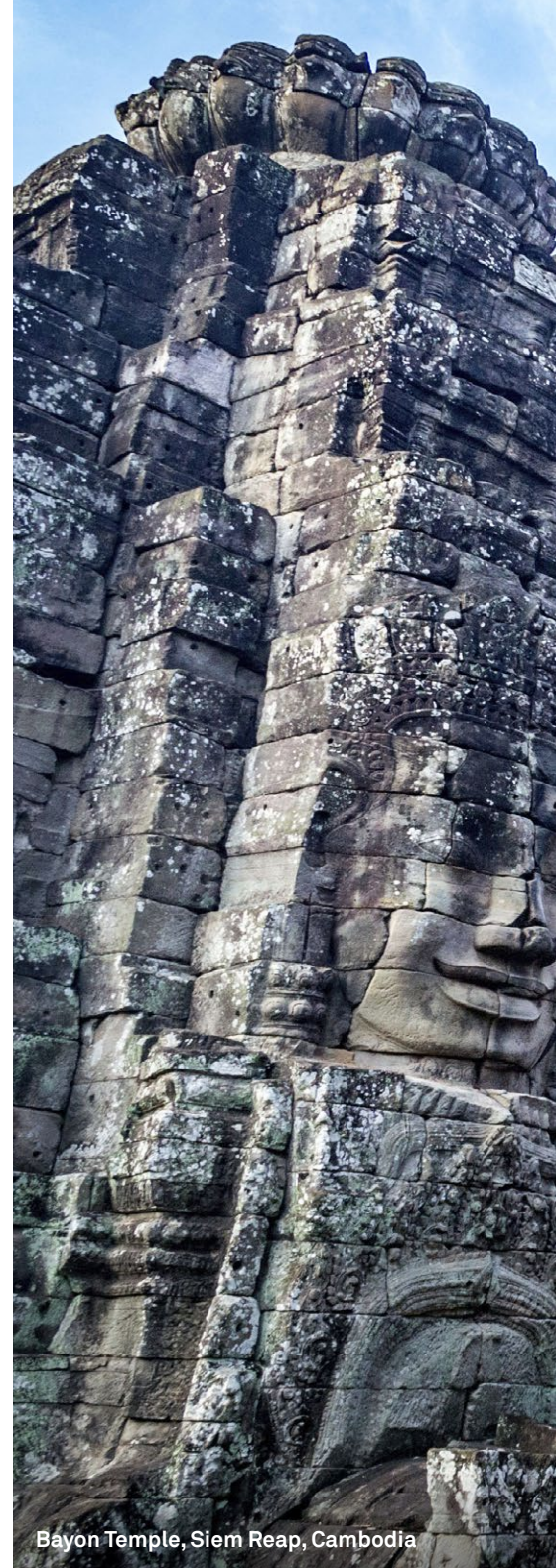

Bayon Temple, Siem Reap, Cambodia



Rice farms, Mekong Delta, Vietnam

[CLICK HERE](#) for the latest offers and up to date availability, or contact your local Travel Agent



Golden Pavilion, Kyoto, Japan

The Scenic Difference:

- Exclusive Gala Dinner at an Angkor temple
- Champagne breakfast at an Angkor temple
- Vespa Foodie night tour of Saigon with Scenic Freechoice
- Night time tuk tuk tour with private after hours distillery visit in Phnom Penh
- Stroll through the 300-year-old Korakuen Garden, one of the Three Great Gardens of Japan
- Play the Taiko drums in an interactive, private group demonstration and lesson
- View a private sumo wrestler demonstration
- Partake in a traditional Tea Ceremony dressed in a kimono in Kyoto

To speak to our friendly and expert team call 0808 258 3966

Luxury Mekong & Japan in Focus

28 Day Itinerary Siem Reap > Osaka

Day 1

UK > Siem Reap

Fly from a choice of UK airports on selected airlines.

Day 2

Siem Reap

Arrive at the Raffles Grand Hotel d'Angkor, your home for a three-night Special Stay.

Meals: D

Day 3

Siem Reap

Freechoice: Discover Banteay Srei and visit the Landmine Museum or produce your own local souvenir at Senteurs d'Angkor workshop. Alternatively, cruise on Tonle Sap (seasonal), take a tuk tuk ride to the markets or take a tethered balloon ride (weather dependent). Later, visit Angkor Wat.

Enrich: Take your premium reserved seat at the colourful Phare, The Cambodian Circus.

Meals: B.L

Day 4

Siem Reap

Enrich: Marvel at sunrise over the magnificent Angkor Wat before moving to a special location for a champagne breakfast with food prepared by an NGO supported local bakery school.

Visit Ta Prohm Temple, Angkor Thom and Bayon Temple.

Enrich: Be wowed by a mystical themed Gala Dinner at an Angkor temple, with complimentary free-flowing drinks and a show featuring Apsara dancers in front of candlelit temple ruins.

Meals: B.D

Day 5

Siem Reap > Mekong Cruise

Drive to Kampong Cham where Scenic Spirit awaits.

Meals: B.L.D

Days 6-11

Luxury Mekong River Cruise

Refer to the full Mekong River Cruise, [CLICK HERE](#).

Day 12

Mekong Cruise > Ho Chi Minh City

Drive to Ho Chi Minh City, visit the War Museum and stay two nights at the Caravelle Saigon.

Freechoice Dining: Enjoy a Vespa foodie tour of Saigon, dine at the Secret Garden restaurant, try Nineteen Restaurant at your hotel or SHRI Restaurant and Lounge.

Meals: B.L.D

Day 13

Ho Chi Minh City

Travel to the Cu Chi Tunnels before exploring the Reunification Palace.

Meals: B.L.D

Day 14

Ho Chi Minh City > Tokyo

Fly to Tokyo and check into the Capitol Hotel Tokyu, your home for the next three nights.

Meals: B.D

Guests travelling on the 16 Day Japan in Focus (code DJPO) arrive in Tokyo today and meet up with your fellow travellers at tonight's welcome dinner.

Day 15

Tokyo

Visit the Asakusa district and Sensoji, the city's oldest Buddhist temple.

Freechoice: Visit the Imperial Shinto Meiji Shrine, before walking across the busiest pedestrian crossing in the world in Shibuya. Alternatively, wander through the picturesque Shinjuku-Gyoen Gardens and entertainment district.

Meals: B.L

Day 16

Tokyo

Begin in the beautiful Imperial Palace's East Gardens then dress up in your chefs' clothes to make your own sushi lunch. Afterwards, wander through Harajuku, the epicentre of Tokyo's teenage youth.

Enrich: Partake in an interactive, private group lesson in playing the Taiko drums.

Freechoice Dining: Choose from dining at a ninja-themed restaurant or the traditional Japanese izakaya bar scene.

Meals: B.L.D

Day 17

Tokyo > Five Lakes > Hakone

See kimonos at the Itchiku Kubota Art Museum. Cruise on Lake Ashinoko before taking a cable car ride up to the Owakudani geothermal area. Enjoy a Special Stay at Odakyu Hotel de Yama.

Meals: B.L.D

Day 18

Hakone > Kyoto

Relax in your Green (Business) Class seats on the Shinkansen train to the culturally rich city of Kyoto. Visit Nijo Castle before settling in for a four-night stay at Kyoto Brighton Hotel.

Meals: B.L.D

Day 19

Kyoto

Begin the day at the famous Kinkaku-ji or Golden Pavilion. Afterwards, glide through the surreal Arashiyama Bamboo Grove by traditional rickshaw before exploring and enjoying a vegetarian meal at the World Heritage-listed Tenryu-ji Temple. This evening, stroll through the Gion area.

Freechoice Dining: Dine at Fortune Garden or try traditional Kaiseki at Gion Sekiya.

Meals: B.L.D

Day 20

Kyoto

Freechoice: Revel in the atmosphere of the ancient preservation districts or visit the Silver Pavilion before strolling along the famous Philosopher's Walk.

Enrich: Partake in a Japanese tea ceremony while dressed in a traditional Japanese kimono.

This afternoon, enjoy some free time in Nishiki Market.

Enrich: Tonight's dinner will allow you to interact with a geiko and maiko who'll host your meal.

It's an excellent opportunity to learn about what is involved in becoming a geisha, and the art of Japanese hospitality.

Meals: B.D

Day 21

Kyoto > Nara

Begin your day with an early visit to Fushimi Inari Shrine then continue to Nara, where you'll visit Todaiji Temple and see deer in Nara Park. Later, stop for a sake tasting at a sake museum.

Meals: B.L

Ryokan Upgrade

Choose to stay tonight in a traditional Ryokan. Includes dinner and breakfast.

Day 22

Kyoto > Himeji > Okayama

Relax on the Shinkansen before marvelling at Himeji Castle. Afterwards, move to Okayama to visit the 300-year-old Korakuen Garden. Continue to Kurashiki and check into the Ivy Square Hotel or similar for the night.

Meals: B.L.D

Day 23

Kurashiki > Hiroshima

Walk around the Kurashiki canal area and visit a former Edo Period merchant house. Travel on the Shinkansen



Lake Ashinoko, Japan

to Hiroshima and check into the Hilton Hiroshima hotel for two nights. Tonight, sample Okonomiyaki.

Meals: B.L.D

Day 24
Hiroshima > Miyajima Island

Sail by ferry to Miyajima Island to visit Daisho-in Temple and the floating Torii Gate at the Itsukushima Shrine.

Enrich: Visit the Peace Park and Museum before visiting Orizuru Tower to create your own special origami crane donation.

Meals: B.L

Day 25
Hiroshima > Osaka

Begin with a visit to the Mazda car factory. This afternoon, travel by Shinkansen back

to Osaka to enjoy a two-night Special Stay at the Hilton Osaka Hotel, staying in an Executive Room with full club lounge access. This evening, catch the Osaka Metro to wander around Dotonbori and Hozenji Yokocho food alley.

Meals: B.L

Day 26
Osaka > Asuka

Drive to the cradle of Japanese culture in Asuka. Wander through the Inabuchi terraced rice paddy fields, the ancient Tobiishi stone bridge and visit Ishibutai Tumulus.

Enrich: Learn about the history, life and training routine of a sumo wrestler during a private visit to a Sumo Museum.

Enjoy your Club Floor benefits before your farewell dinner.

Meals: B.L.D

Day 27
Osaka > UK

Depart today with treasured memories. Transfer to the airport for your flight home.

Meals: B

Day 28
Arrive UK
 Welcome home.

5-star luxury inclusions:

- Fly from a selection of UK airports
- 5-star Scenic ship with luxurious one-bedroom balcony suites
- 10 exclusive Scenic Enrich experiences
- Your choice of 31 Scenic Freechoice activities and dining
- 1 Scenic Sunset Drinks event during your cruise
- 3 memorable Scenic Special Stays
- Up to four on board dining options, from casual to fine dining
- 66 meals – 25 breakfasts (B), 21 lunches (L) and 20 dinners (D)
- Complimentary beverages all day throughout your Mekong cruise
- Butler service for all guests throughout your Mekong cruise
- Scenic Cruise Director and Tour Director with local guides
- Complimentary Wi-Fi throughout your cruise
- All tipping and gratuities

DECK	JEWEL	SAPPHIRE DECK			DIAMOND DECK		
Suite Categories	Deluxe Suite C/CA From	Deluxe Suite BA From	Deluxe Suite BB From	Deluxe Suite B From	Deluxe Suite A From	Grand Deluxe RD From	Royal Panorama RS From
2023							
Oct 20	£18,240	£19,035	£19,135	£19,235	£19,635	£19,835	£21,235

Please note: The Mekong River and Tonle Sap Lake are subject to extreme variations in water levels throughout the year. Every effort is made to adhere to the brochure itinerary however changes including early disembarkation may be necessary due to river conditions, on advice of local authorities or for safety reasons.

Terms and Conditions: All prices are per person based on a twin share. Disruptions to cruising and alteration to itinerary arrangements may occur. Flights are in economy class, flight routes are subject to availability. Full payment is required within 120 days of departure. Itinerary and departure date are subject to change. Hotel is indicative and subject to change. For full terms and conditions please refer to pages 68-71.

To speak to our friendly and expert team call 0808 258 3966



Enrich your world with Scenic

For 37 years, the pursuit of wonder has led Scenic to search more than 60 countries to create unique luxury itineraries.



Scenic Space-Ship, Budapest, Hungary

Unforgettable handcrafted land journeys

Australia, New Zealand, Canada, Africa and Egypt

Scenic's handcrafted luxury land journeys are meticulously designed to capture the extraordinary wonders of the destinations. The all-inclusive sightseeing and services of a dedicated Tour Director and knowledgeable local guides make the journey truly unforgettable. Via distinctive elements such as historic hotels for Scenic Special Stays and iconic, luxurious rail journeys to take in the scenery, Scenic's land journeys are handcrafted to be wonderfully relaxing.

Truly All-Inclusive River Cruising

Europe and South East Asia

Scenic's 5-star Space-Ships cruise the historic waterways of Europe. Designed to navigate Europe's rivers, whilst providing you with abundant space on board to have a relaxing river cruise experience. With up to only 163 guests, our ships provide a more personalised and intimate environment for guests to relax, make friends and enjoy the truly all-inclusive luxury experience. With thoughtful inclusions such as Scenic Culinaire, a cooking school on board the South of France and Bordeaux based ships, a Salt Therapy Lounge on board Scenic Space-Ships that cruise the Rhine, Main, Danube, South of France and Bordeaux regions, with Scenic you get the best unique experiences in 5-star luxury.

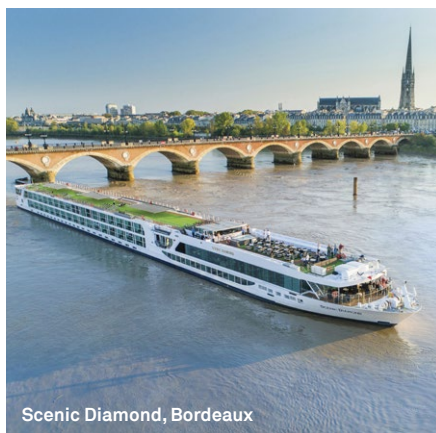

Scenic Diamond, Bordeaux

Extraordinary Ocean Voyages

Antarctica, the Arctic, Europe & the Mediterranean, the Americas, South Pacific and more

Combining innovative design, world-class facilities and state-of-the-art technology, Scenic Eclipse sets the benchmark in 6-star cruising. Unrivalled worldwide discovery in truly all-inclusive ultra-luxury, exceptional once-in-a-lifetime experiences, and a dedicated crew await on board The World's First Discovery Yachts™.

Go above the horizon in one of two on board helicopters[^], or delve below on the custom-built submarine, Scenic Neptune[^]. Indulge in the on board spaces, with luxuriously appointed suites, the spacious 550m² Senses Spa, and up to 10 exceptional dining experiences. Be immersed in the extraordinary with exceptional on shore experiences, led by an expert Discovery Team. This is where ultra-luxury meets discovery.

[^]Helicopter and submarine experiences at additional cost, subject to regulatory approval, availability, weight restrictions, medical approval and weather and ice conditions. Helicopters are unable to operate in South Georgia and Svalbard. Submarine is unable to operate in US waters.



Brown bears, Canada



Scenic Eclipse, Antarctica



Milford Sound, New Zealand

We would be delighted to assist you to plan and book your next journey.
For more information, **CLICK HERE** or visit your local Travel Agent.

SCENIC°CLUB

It's more than a membership... Welcome to Scenic Club, our rewards and recognition program where we put our guests at the heart of everything we do.

As a Scenic Club member, expand your horizons by unlocking coveted rewards and recognition benefits when you travel across our portfolio of luxury river and yacht cruises and land journeys. The more you travel with us, the greater the experiences and rewards you will receive. Scenic members collect from 100 tier points a day on any Scenic land journey, and your tier points then increase based on your selected deck and suite of choice when you travel on our Europe River Cruises and Scenic Eclipse. Best of all, membership is complimentary.

Benefit	Gold	Platinum	Diamond	Emerald	Benefit	Gold	Platinum	Diamond	Emerald
Welcome Home voucher* to redeem on your next cruise or tour	£100	£100	£100	£150	Complimentary pre or post-night hotel stay for trips of 20 days or more ⁺		○	○	○
Welcome Home voucher* to redeem on your next cruise or tour if two or more tours are booked in the same reservation	£200	£200	£200	£300	Access to exclusive member only offers and itineraries		○	○	○
Refer a Friend voucher, entitling any new guest referral to a discount. The referring guest will earn a £100 Referral Credit when this voucher is redeemed and deposited*	£100	£100	£100	£100	Choice of either a premium Scenic Club trolley case or a £75 gift card prior to each departure ^{^≈}			○	○
Choice of a Scenic Club merchandise or luggage received prior to every trip ^{^≈}	○	○	○	○	Extended distance allowance for the private door-to-door transfers		○	○	○
Dedicated members only help desk, for a quick response to any queries, issues or requests	○	○	○	○	Exclusive Scenic Club Diamond offers			○	
Member only offers on selected itineraries	○	○	○	○	Exclusive Emerald travel wallet				○
Priority on pre-release tours and cruises	○	○	○	○	Upgraded hotel categories for pre or post accommodation when available*				○
Member only competitions and events	○	○	○	○	Exclusive Scenic Club Emerald events				○
Scenic Club Wonder magazine	○	○	○	○	Benefit - River Cruising				
The very latest updates and information via Scenic e-news	○	○	○	○	Additional benefits are available for Emerald members* (see website)				○
Scenic Club Member Only mailings		○	○	○	Benefit - Scenic Eclipse				
Private door-to-door transfers before and after travel (location and distance restrictions apply)		○	○	○	Additional benefits are available for Diamond and Emerald members* (see website)			○	○



Qualify after your first paid trip.



Qualify after earning 5,000 Points.



Qualify after earning 10,000 Points.



Qualify after earning 25,000 Points.

Conditions apply. For the most up-to-date details of member benefits and terms and conditions, please visit the Scenic website. All benefits of the loyalty program are subject to availability and subject to change. We reserve the right to modify, replace or remove any aspect of the program without notice. ⁺Available on trips of 7 days or more only. [^]Select via Tour Personaliser eight weeks prior to departure tp.scenicglobal.com ^{}The 20 days required to qualify for this benefit can be made up of the total paid days for travel, so can include paid add-on days, such as stopovers, journey extensions and/or back-to-back journeys. Hotels available for this benefit are subject to change.

For more information [CLICK HERE](#)



Accommodation Special Stays

- A Capitol Hotel, Tokyu, Japan
 B Hoshino Resorts Oirase Keiryu Hotel, Lake Towada, Japan
 C Hilton Osaka, Japan

With Scenic Special Stays, you will enjoy iconic properties remarkable for their location, character and heritage, a truly luxurious experience unlike any other. Look for the Special Stays symbol on your itinerary indicating the locations where these outstanding accommodations are available.

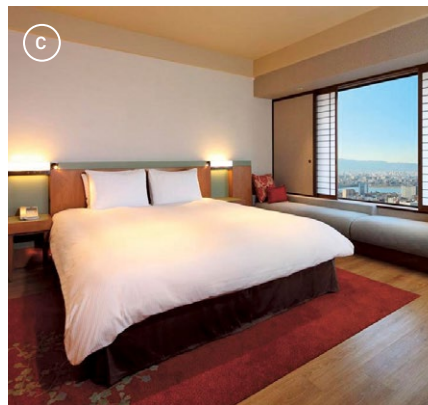
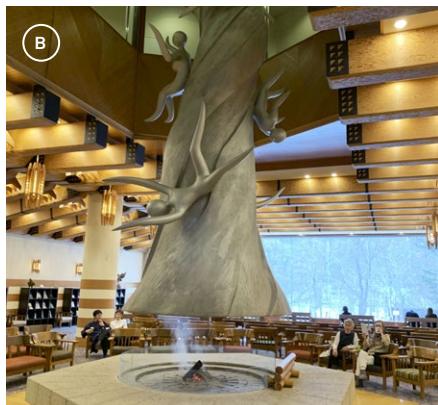

Location	Description
Iwate, Japan	Hanamaki Onsen Kashoen An untouched gem located amid the mountains and ornate green Akamatsu pine trees. This hotel is like no other with beautifully appointed traditional Japanese and western rooms offering luxuries suitable for all travellers.

Lake Towada, Japan	Hoshino Resorts Oirase Keiryu Hotel Known as one of the most picturesque locations in Japan. Guests can soak up the awe-inspiring facilities and modern rooms of this luxurious hotel surrounded by natural hot springs.
--------------------	--

Seoul, South Korea	LOTTE Hotel Seoul - Executive Tower Stay in Executive rooms with Club access in this stylish and modern property located amidst the excitement of Seoul city centre. Step into elegant surroundings with luxuriously appointed rooms, premium bedding and high-speed Wi-Fi.
--------------------	---

Kanazawa, Japan	Hyatt Centric Kanazawa This hotel offers rooms overlooking the city, whilst its design reflects the history of the Kanazawa region.
-----------------	---

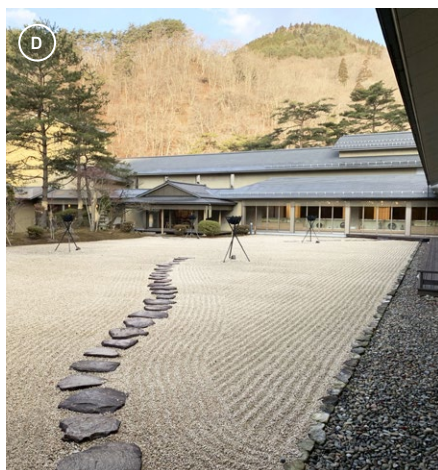

Location	Description
Tokyo, Japan	Capitol Hotel Tokyu A tranquil haven located in the heart of Tokyo and recently rated in the Forbes Travel Guide as Tokyo's Exclusive Japanese style hotel. The Capitol Hotel Tokyu offers a modern take intertwined with traditional Japanese furnishings and features a wide range of facilities including restaurants, bars, a spa, fitness club and a large swimming pool.

Osaka, Japan	Hilton Osaka Situated in the heart of the business district, connected to a large shopping mall, the Hilton Osaka offers modern amenities, large windows and beautiful views over the city from your Executive Room.
--------------	--



Accommodation

The Finest Hotels

A LOTTE Hotel Seoul - Executive Tower, South Korea
 B Grand Hyatt Fukuoka, Japan

Scenic's selected accommodation is all about combining luxury with a unique atmosphere. Your hotel will always have a handpicked location, often be historical, and, without exception, offer best-in-class service so you can relax and indulge wherever your Scenic journey takes you.



Location	Description
Fukuoka, Japan	Grand Hyatt Fukuoka Connected to Canal City Hakata entertainment and shopping complex, the Grand Hyatt Fukuoka offers modern design and a range of services including a fitness centre, spa and complimentary Wi-Fi.
Sapporo, Japan	Sapporo Grand Hotel A Western-style hotel located amongst Chuo's most iconic landmarks, including Hanamaru JR Tower Stellar Place, a wide range of accommodation, amenities, delicious cuisine and places to visit, ensure guests are spoiled for choice.
Gwangju, South Korea	Holiday Inn Decorated in beige wood and calming green, rooms are illuminate and you can choose from a pillow menu.
Gyeongju, South Korea	Gyeongju Hilton Hotel Enjoy a fitness centre, squash court, and indoor and outdoor pools with private cabanas.
Busan, South Korea	Paradise Hotel Luxurious oceanfront accommodation with sea views.
Ho Chi Minh City, Vietnam	Caravelle Saigon Enjoy a spacious walk-in vanity, shower including amenities from the Appelles Classic range, all beautifully finished with marble.
Siem Reap, Cambodia	Raffles Grand Hotel This hub of tranquillity is the ultimate 5-star hotel. Beautifully-appointed rooms offer unique fusions of old and new.
Kurashiki, Japan	Ivy Square Hotel Formerly a cotton mill, Kurashiki Ivy Square is a multi-purpose hotel, inside can be found a shop and a cultural facility. Located in the Kurashiki Bikan Historical Quarter, it is perfect as a base for sightseeing.
Nara, Japan	JW Marriott Hotel Nara The JW Marriott Nara, the first international luxury hotel in Nara, Japan, welcomes guests to enjoy experiential sophistication with a truly personal touch.
Nara, Japan	Ryokan Hotel For a unique insight into Japanese culture, choose to stay in a Ryokan (at additional cost, must be pre-booked before departure). This traditional Japanese Inn has tatami mat flooring with futon beds, sliding shoji paper doors, onsen hot spring baths and private facilities, and includes dinner and breakfast.
Hakone, Japan	Odakyu Hotel de Yama Situated right next to the picturesque Lake Ashi in the Hakone region, Odakyu Hotel de Yama boasts large Japanese gardens with various flowers, and natural hot spring baths that are surrounded by lush trees.
Hiroshima, Japan	Hilton Hiroshima The newly built 420-room Hilton Hiroshima features four restaurants, a fitness centre, spa and indoor swimming pool.

Location	Description
Kyoto, Japan	Brighton Hotel Situated in the heart of Kyoto, quiet suites feel far away from the hustle and bustle.
Five Lakes, Japan	Fuji Marriott Hotel Lake Yamanaka Relax in a spacious room, all of which are 41 square meters or more, featuring complimentary high-speed WiFi.
Takayama, Japan	Hotel Associa Takayama Resort Located in the surrounding mountains with amazing views overlooking Takayama city and the Japanese Alps.
Nekoma, Japan	Lake Resort Nekoma Rikyu Take a break from the hustle and bustle of everyday life surrounded by the majestic nature of Nekoma.
Aomori, Japan	Hotel Aomori Just a 6-minute drive from JR Aomori Station, Hotel Aomori features a restaurant and an onsite bar.



Arashiyama Bamboo Grove, Kyoto, Japan
N 35° 01' E 135° 40'

Scenic Spirit

Built 2016 | Passengers 68 | Suites 34 | Crew 50 | Length 85 metres

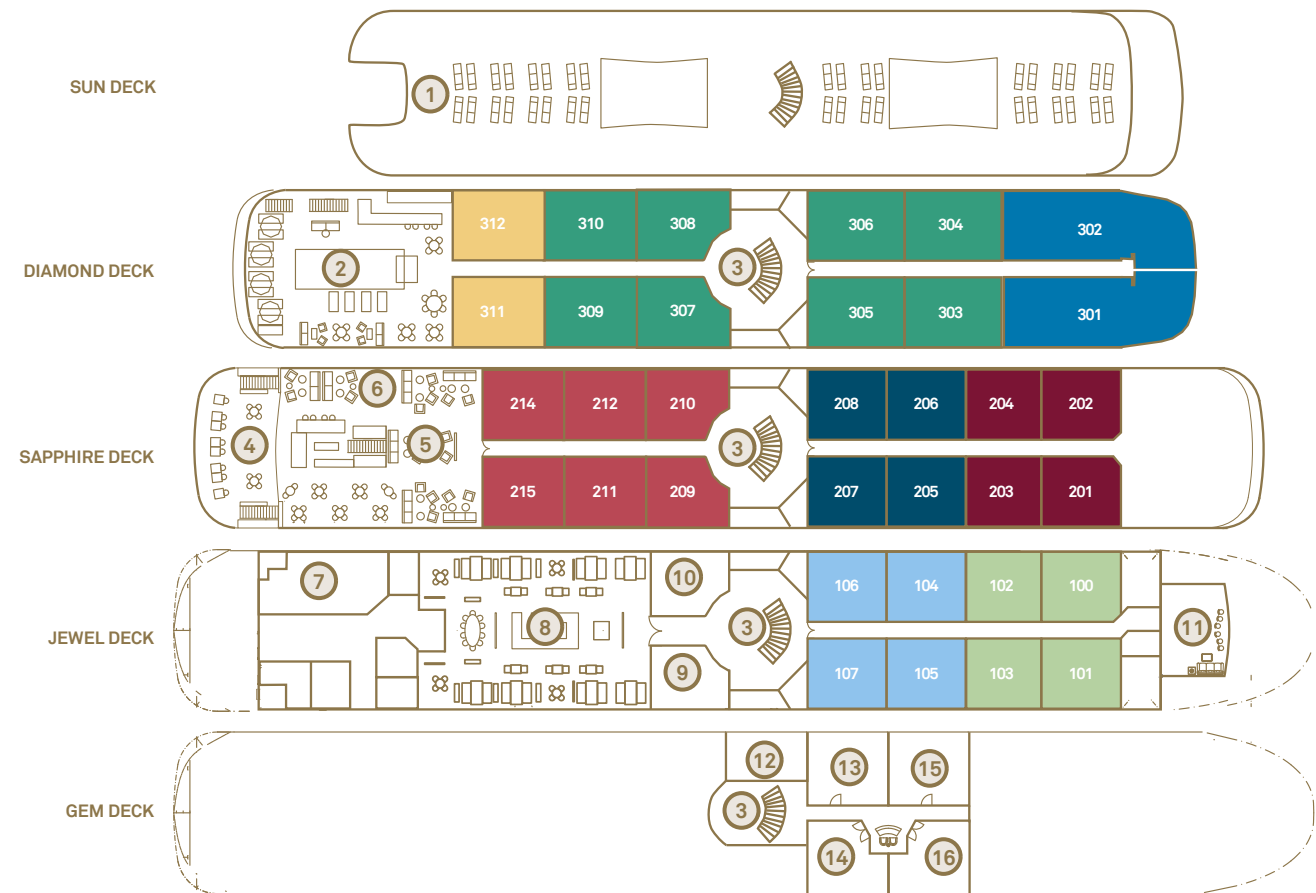
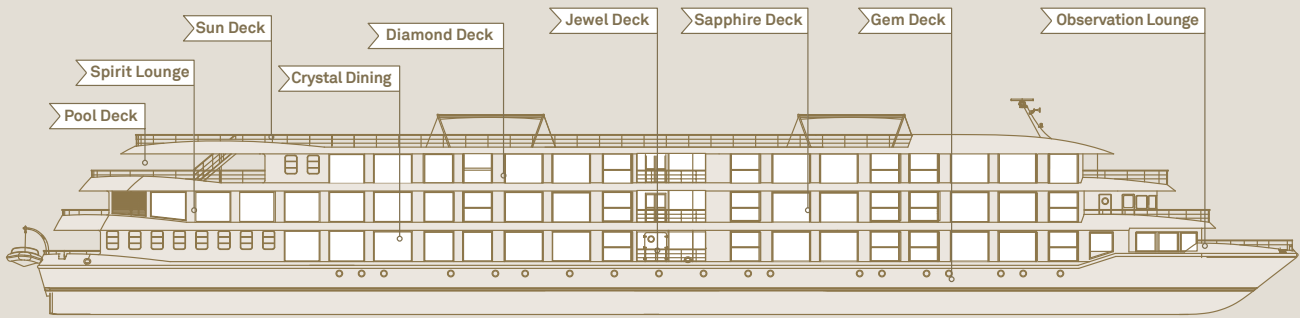

Deck Plan

- ① Sun Deck and Open Air Cinema
- ② Pool and Bar
- ③ Elevator
- ④ Outdoor Lounge
- ⑤ Spirit Lounge
- ⑥ River Café
- ⑦ Galley
- ⑧ Crystal Dining
- ⑨ Gift Shop
- ⑩ Reception
- ⑪ Library
- ⑫ Guest Laundry
- ⑬ Gym
- ⑭ Beauty Salon
- ⑮ Steam Sauna
- ⑯ Wellness Centre

Cabin Categories

Diamond Deck		Sapphire Deck		Jewel Deck	
RS	Royal Panorama Suite	B	Deluxe Suite	C	Deluxe Suite
RD	Grand Deluxe Suite	BB	Deluxe Suite	CA	Deluxe Suite
A	Deluxe Suite	BA	Deluxe Suite		

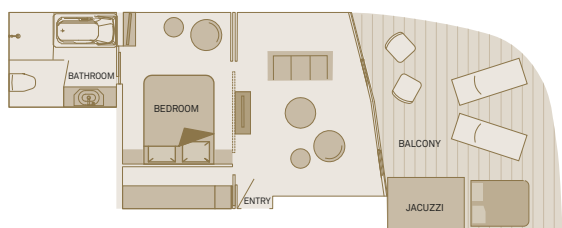

Royal Panorama Suite

Including Private Outdoor Terrace
80m²/861ft²

RS

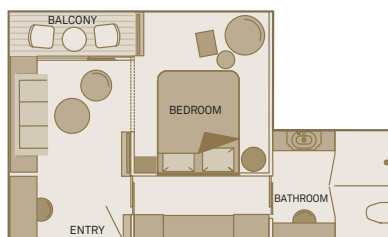

Grand Deluxe Suite

Including Scenic Sun Lounge
40m²/430ft²

RD

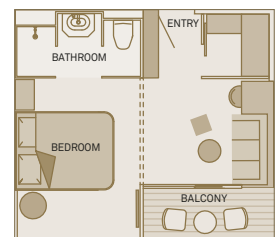

Deluxe Suite

Including Scenic Sun Lounge
32m²/344ft²

A B BB BA C CA

The deckplan and cabin layout images are an indication only and may vary.



Terms and Conditions

Booking conditions

Important: The following terms and conditions together with the general information contained in our brochure form the basis of your contract with Scenic Tours (UK) Limited, 4 Piccadilly Place, Manchester, UK, M1 3BN, company number 05770865. Please read them carefully as they set out our respective rights and obligations and in particular note that:

- If for any reason you cancel your holiday, cancellation charges will apply and may be up to 100% of the booking cost. We may also cancel your booking;
- You may make amendments to your booking but there will be a charge for this and we can change your booking where it is necessary for us to do so;
- You should take out travel insurance that is appropriate to your needs;
- We provide financial security as required by The Package Travel and Linked Travel Arrangements Regulations 2018 for package holidays through our membership with ABTA (membership number: Y6328) and for flight inclusive holidays our ATOL membership (number 9294);
- Some of the flights and flight-inclusive holidays in our brochure are financially protected by the ATOL scheme. But ATOL protection does not apply to all holiday and travel services listed in this brochure. Our website will provide you with information on the protection that applies in the case of each holiday and travel service offered before you make your booking. If you do not receive an ATOL Certificate then the booking will not be ATOL protected. Please see read our booking conditions for information, or for more information about financial protection and the ATOL Certificate go to: www.caa.co.uk

- We are responsible for your package holiday subject to the terms of these Booking Conditions and will pay you compensation when appropriate.
- In order for us to process your booking and provide the journey to you, you will need to provide us, and we will need to use your personal information. We will also need to provide your personal information to service providers. By making a booking you give us your consent to use and disclose your personal information in the manner described.

By asking us to confirm your booking, we are entitled to assume that you have had the opportunity to read and have read these booking conditions and agree to them. Except where otherwise stated, these booking conditions only apply to journey arrangements (including pre and post journey accommodation, activities and other services) which you book with us and pay for before departure and which we agree to make, provide or perform (as applicable) as part of our contract with you. All references in these booking conditions to "holiday", "booking", "cruise", "journey" or "arrangements" mean such journey arrangements unless otherwise stated. In these booking conditions, "you" and "your" means all persons named on the booking (including anyone who is added or substituted at a later date) or any of them as the context requires. "We", "us" and "our" means Scenic Tours Europe Limited.

We are a Member of ABTA. When you book with an ABTA Member you can expect high service standards, fair terms of trading and accurate information. ABTA's strict joining criteria for Members, code of conduct, customer helpline and approved Alternative Dispute Resolution (ADR) scheme to resolve complaints are all there to give you confidence and peace of mind when booking your travel arrangements. For more information see www.abta.com.

Bookings

1. We welcome passengers with medical conditions or disabilities. If you or any member of your party has any medical condition or disability which may affect your journey or has any special requirements as a result of any medical condition or disability (including any which affect the booking process), it is very important that you tell us of the condition and of any medical or mobility equipment you will need in writing before you confirm your booking so that we can assist you in considering the suitability of the arrangements and/or making the booking. You must also notify us of any changes or deterioration in the disability or medical condition or development of any disability or medical condition after booking. We must reserve the right to decline a reservation of any person or, if full details are not given at the time of booking or the condition/disability develops after booking, cancel when we become aware of these details, if we reasonably feel unable to properly accommodate their particular needs. In the event that you require assistance with embarking or disembarking as a result of your reduced mobility or disability, please advise us at the time of booking and in any event no later than 48 hours before the assistance is required. Please also note that assistance is not always available when embarking or disembarking at all ports of call. Any passenger affected by a disability or medical condition must ensure they have notified this to their travel insurers and that their travel insurance will provide a suitable level of cover (see clause 36 for more information about insurance).

2. The operation of all journeys is conditional on us securing the minimum number of bookings required to operate the journey and to ensure an enjoyable group atmosphere. Where sufficient numbers cannot be achieved, we reserve the right to cancel or change a scheduled journey. Please also see clauses 18 and 19. We will notify you no less than 60 days prior to the departure date of the journey if we have to cancel or significantly change a journey due to lack of numbers.

3. If you have any special requests (including dietary requirements) you must notify us in writing at the time of booking. Please note special requests cannot be guaranteed. Failure to meet any special request will not be a breach of contract by us. Confirmation that a special request has been noted or passed on to the supplier of any service(s) or the inclusion of the special request on your confirmation invoice or any other documentation is not confirmation that the request will be met. Unless and until specifically confirmed, all special requests are subject to availability. For your own protection, you should obtain confirmation in writing that a special request will be complied (where it is possible to give this) where it is important to you. We cannot accept any conditional bookings, i.e. any booking which is specified to be conditional on the fulfilment of a particular request. All such bookings will be treated as "standard" bookings subject to the above provisions on special requests.

Payment

4. To make a booking, you must pay the applicable deposit of a minimum of £1,250 per person or full payment if booking 120 days. If you make a provisional booking the deposit or full payment, as applicable, must be received by us at the time of booking to ensure a place on the journey is held. We will automatically assume that you do not wish to proceed with a booking if the applicable deposit or full payment, as applicable, is not received by us and we will have no further liability to you. Any accommodation, sightseeing or flights we book for you which are separate to those stated in your itinerary are not included in the deposit or journey price. An extra payment will be required to cover the costs of these additional services, and these services will not be booked until both your holiday deposit and additional service costs are paid in full.

5. Deposits are non-transferable and non-refundable except as expressly set out in these terms and conditions. We therefore recommend that you take out adequate insurance prior to booking.

6. The balance of the journey price (after deduction of the applicable deposit) must be received by us no less than 120 days prior to the start of your journey. If we do not receive all payments due (including any surcharge where applicable) in full and on time, we are entitled to assume that you wish to cancel your booking. In this case, we will be entitled to keep all deposits paid or due at that date. If we do not cancel straight away because you have promised to make payment, you must pay the cancellation charges shown in these terms and conditions depending on the date we reasonably treat your booking as cancelled.

7. Except for flight inclusive bookings, all monies you pay to one of our authorised travel agents for your holiday with us will be held by the agent on your behalf until a contract between us comes into existence. After that point, your agent will hold the monies on our behalf until they are paid to us. For flight inclusive bookings, all monies paid to any authorised travel agent of ours for your holiday with us will be held on behalf of and for the benefit of the Trustees of the Air Travel Trust subject to the travel agent's obligation to pay such monies to us in accordance with our trading terms unless we fail. In the unlikely event of our financial failure, all monies then held by the travel agent or subsequently paid by you to the travel agent will be held by the agent on behalf of and for the benefit of the Trustees of the Air Travel Trust without any obligation on the agent to pay such monies to us.

8. Credit Card Payments (No charge for debit/credit cards)

Your contract

9. Subject to availability we will confirm your booking by issuing our confirmation invoice. This invoice will be sent to the lead name on the booking ("Lead Name") or your Travel Agent. Please check this invoice carefully as soon as you receive it. Contact us immediately if any information on the confirmation or any other document appears to be incorrect or incomplete as it may not be possible to make changes later. We cannot accept any liability if not notified of any inaccuracy in any document within 7 days of our sending it out. We will do our best to rectify any mistake notified to us outside these time limits but you must meet any costs involved in doing so.

10. A binding contract between you and us comes into existence when we issue our confirmation invoice. We both agree that English law (and no other) will apply to your contract and to any dispute, claim or other matter of any description which arises between us ("claim") (except as set out below). We both also agree that any claim (and whether or not involving any personal injury) must be dealt with under the ABTA Alternative Dispute Resolution Scheme ("ADR") (if the scheme is available for the claim in question and you wish to use it – see the clause 43) or by the Courts of England and Wales only unless, in the case of court proceedings, you live in Scotland or Northern Ireland. In this case, proceedings must either be brought in the courts of your home country or those of England and Wales. If proceedings are brought in Scotland or Northern Ireland, you may choose to have your contract and any claim or other matter of any description which arises between us governed by the law of Scotland/Northern Ireland as applicable (but if you do not so choose, English law will apply).

What are your obligations?

11. (a) You must follow the Captain, Tour and Cruise Director's instructions at all times. You acknowledge that failure to do so may result in restricted access to areas on journey, or if necessary for your own safety and/or that of other passengers, withdrawal from the journey. (b) We expect all clients to have consideration for other people. If

in our reasonable opinion, or in the reasonable opinion of any other person in authority, you behave in such a way as to cause or be likely to cause danger, upset or distress to yourself or any third party or damage to property we are entitled, without prior notice, to terminate the journey of the person(s) concerned. We will not be liable to you for any loss, cost or damage resulting from your withdrawal. If you are withdrawn from the journey, you must make your own return travel arrangements at your own expense.

Journey price

12. Please note, changes and errors occasionally occur. You must check the price of your chosen holiday at the time of booking. We reserve the right to make changes to and correct errors in advertised prices at any time before your holiday is confirmed. We will advise you of any error of which we are aware and of the then applicable price at the time of booking. Once the journey price has been confirmed at the time of booking, clause 13 below will apply.

13. Once your journey price has been confirmed at the time of booking, then subject to the correction of errors, it will only be increased or decreased in the following circumstances. A surcharge or refund (as applicable) will be payable, subject to the conditions set out below, in the event of any change in our transportation costs or in dues, taxes, fuel or fees payable for services such as landing taxes or embarkation or disembarkation fees at ports or airports increase or decrease or in the exchange rates which have been used to calculate your journey price. Even in the circumstances set out in above, only if the amount of the increase in our costs exceeds 2% of your journey price (excluding insurance premiums and any amendment fee) will we levy a surcharge. If any surcharge is greater than 8% of your journey price (excluding insurance premiums and any amendment fee), you will be entitled to cancel your booking and receive a full refund of all monies you have paid to us (except for any amendment fee) or alternatively purchase another journey from us – see clause 18. You have 14 days from the issue date printed on the surcharge invoice to tell us if you wish to cancel or purchase another journey where applicable. Otherwise, we are entitled to assume that you do not wish to do so and will pay the surcharge. Any surcharge must be paid with the balance of the journey price or within 14 days of the issue date printed on the surcharge invoice, whichever is the later. Please note that travel arrangements are not always purchased in local currency and some apparent changes have no impact on the journey price due to contractual and other protection in place. A refund will only be payable if the decrease in our costs exceeds 2% as set out above. Where a refund is due, we will pay you the full amount of the decrease in our costs. No surcharge will be levied within 30 days of departure. No refund will be payable if any decrease in our costs occurs during this period either.

Journey features

14. We make no representations about the features of any journey other than those expressly set out in the journey brochure and these terms and conditions.

Brochure validity

15. The journey brochure and these terms and conditions are valid for the departure dates as stated in the journey brochure unless extra dates are added or otherwise expressly advised by us.

Variation or cancellation by us

16. We start planning the journeys we offer many months in advance. Occasionally, we have to make changes to and correct errors in the details of advertised journeys both before and after bookings have been confirmed and cancel confirmed bookings.

17. In the event of industrial action affecting air, rail, cruise or other journey related transportation we will make every effort to contact the lead name and advise of alternative arrangements (if any). However, if contact is not made, you should phone 0808 231 3933.

18. Whilst we always endeavour to avoid changes and cancellations, we must reserve the right to do so. However, due to the nature of travel, it may not always be possible for us to adhere strictly to your Itinerary and the Operator may need to make alterations to the journey or your Itinerary, before or after the commencement of the journey. Where, due to circumstances outside the Operators control, we are unable to provide the journey in accordance with your Itinerary, we will use reasonable endeavours to: (a) give you reasonable notice of any alterations, but there may be circumstances beyond our control in which alterations will be required with little, or no, advance notice; and (b) provide or arrange appropriate alternative activities, transport and accommodation as required. Occasionally, we have to make a significant change to or cancel a confirmed journey and we must reserve the right to do so. A significant change is a change made before departure which, taking account of the information you give us at the time of booking or which we can reasonably be expected to know as a tour operator, we can reasonably expect to have a significant effect on your journey. If we have to make a significant change or cancel, we will tell you as soon as possible. If there is time to do so before departure, you will be offered the choice of the following options:- (a) (for significant changes) accepting the changed arrangements or (b) purchasing alternative arrangements from us, of a similar standard to those booked if available. We will offer you at least one alternative holiday of equivalent or higher standard for which you will not be asked to pay any more than the price of the original holiday. If this holiday is in fact cheaper than

the original one, we will refund the price difference. If you do not wish to accept the holiday we specifically offer you, you may choose any of our other then available holidays. You must pay the applicable price of any such holiday. This will mean your paying more if it is more expensive or receiving a refund if it is cheaper or (c) cancelling or accepting the cancellation and receiving a full refund of all monies you have paid to us. Please note, the above options are not available where any change made is a minor one. A change of flight time of less than 12 hours, airline (except as specified in clauses 48-51 "Flights"), type of aircraft (if advised) or destination airport will all be treated as minor changes.

19. If any we have to make a significant change to or cancel a confirmed journey, we will in addition to the options set out in clause 18 pay you compensation depending on the circumstances and when the significant change or cancellation is notified to you subject to the following exceptions. Compensation will not be payable and no liability beyond offering the options set out in clause 18 can be accepted where (1) we are forced to make a change or cancel as a result of unusual and unforeseeable circumstances beyond our control, the consequences of which we could not have avoided even with all due care or (2) we have to cancel because the minimum number of bookings necessary for us to operate your journey has not been reached – see clause 2. No compensation will be payable and the options set out in clause 18 will not be available if we have to cancel as a result of your failure to comply with any requirement of these terms and conditions entitling us to cancel (such as paying on time) or where a change is a minor one.

20. Very rarely, we may be forced by Force Majeure (see clause 34) to change or terminate your journey after departure but before the scheduled end of your time away. This is extremely unlikely but if this situation does occur, we will be unable to make any refunds (unless we obtain any refunds from our suppliers which we do not use to pay for alternative services), pay you any compensation or meet any costs or expenses you incur as a result.

Amendment or cancellation by you

21. If any member of your party is prevented from travelling, the person(s) concerned may transfer their place to someone else (introduced by you) providing we are notified not less than 90 days before departure. Where a transfer to a person of your choice can be made, all costs and charges incurred by us and/or incurred or imposed by any of our suppliers as a result together with an amendment fee of £50 per person must be paid before the transfer can be effected. Any overdue balance payment must also be received. For flight inclusive bookings, you must pay the charges levied by the airline concerned. As most airlines do not permit name changes after tickets have been issued for any reason, these charges are likely to be the full cost of the flight.

22. If you wish to make any amendments to your confirmed booking you must notify us in writing as soon as possible. It may not always be possible to make such amendments. Where we can, an amendment fee of £50 per person per booking will be payable together with any costs incurred by ourselves and any costs or charges incurred or imposed by any of our suppliers. A change of journey dates will normally be treated as a cancellation of the original booking and rebooking in which case cancellation charges will apply. Changes may result in the recalculation of the journey price where, for example, the basis on which the price of the original journey was calculated has changed.

23. You may cancel your booking by notice to us in writing and payment of the applicable cancellation fee as shown below. Cancellation notifications are not effective until received by us in writing (if received by us on a weekend day or public holiday the notification will be treated as having been received by us on the next working day).

The following cancellation fees apply to each person(s) cancelling and where shown as a percentage are based on the total cost of the arrangements which are being cancelled excluding any insurance premiums, amendment fee or previously incurred cancellation charges which are all non-refundable in the event of your cancellation:

Cancellation Fees

24. Days of notice prior to journey commencement
120 days and over Loss of deposit
119 - 91 days 50% of journey price
90 days & less 100% of journey price

NB. Transferring to another date is treated as a cancellation and the cancellation fees above will apply. Depending on the reason for cancellation, you may be able to reclaim these cancellation charges (less any applicable excess) under the terms of your insurance policy. Claims must be made directly to the insurance company concerned.

Where any cancellation reduces the number of full paying party members below the number on which the price, number of free places and/or any concessions agreed for your booking were based, we will recalculate these items and re-invoice you accordingly.

Our liability

25. We will ensure that the journey arrangements we have agreed to make, perform or provide as applicable as part of our contract with you are made, performed or provided with reasonable skill and care. This means that, subject to these terms and conditions, we will accept responsibility if, for example, you suffer death or personal injury or your contracted journey arrangements are not provided as promised or prove deficient as a result of the failure of us, our employees, agents or suppliers to use reasonable skill and care in making, performing or providing, as applicable, your contracted journey arrangements. Please note, it is your responsibility to show that reasonable skill and care has not been used if you wish to make a claim

against us. In addition, we will only be responsible for what our employees, agents and suppliers do or do not do if they were at the time acting within the course of their employment (for employees) or carrying out work we had asked them to do (for agents and suppliers).

We will not be responsible for any injury, illness, death, loss (including loss of enjoyment or possessions), damage, expense, cost or other sum or claim of any description whatsoever which results from any of the following:-

- the act(s) and/or omission(s) of the person(s) affected or any member(s) of their party or
- the act(s) and/or omission(s) of a third party not connected with the provision of your journey and which were unforeseeable/unavoidable or
- Force Majeure as defined at clause 34 below.

26. We cannot accept responsibility for any services which do not form part of our contract with you. This includes, for example, any additional services or facilities which any hotel or other supplier agrees to provide for you where the services or facilities are not advertised in our journey brochure as part of your journey and we have not agreed to arrange them as part of our contract and any excursion or other services you purchase during your journey. Where any such excursion or services are purchased through or with our assistance, please note that we act only as booking agent. Your contract will be with the operator or provider of the excursion or services in question. We have no liability in relation to the same. In addition, regardless of any wording used by us on our website, in any of our brochures or elsewhere, we only promise to use reasonable skill and care as set out above and we do not have any greater or different liability to you.

27. The promises we make to you about the services we have agreed to provide or arrange as part of our contract and the laws and regulations of the country in which your claim or complaint occurred will be used as the basis for deciding whether the journey arrangements in question had been properly provided. If the particular arrangements which gave rise to the claim or complaint complied with the then applicable local laws and regulations, the services will be treated as having been properly performed or provided. This will be the case even if the arrangements did not comply with the laws and regulations of the UK which would have applied had those arrangements been provided in the UK. The exception to this is where the claim or complaint concerns the absence of a safety feature which might lead a reasonable journey participant to refuse to take the journey in question. Please note, however, our obligation is to exercise reasonable skill and care as referred to in clause 24. We do not make any representation or commitment that all services will comply with applicable local laws and regulations and failure to comply does not automatically mean we have not exercised reasonable skill and care.

28. As set out in these booking conditions, we limit the maximum amount we may have to pay you for any claims you may make against us. Where we are found liable for loss of and/or damage to any luggage or personal possessions (including money), the maximum amount we will have to pay you is £1000 per person affected unless a different limitation applies to your claim under this clause or clause 29 below. For all other claims which do not involve death or personal injury, if we are found liable to you on any basis the maximum amount we will have to pay you is twice the price (excluding insurance premiums and amendment fees) paid by or on behalf of the person(s) affected in total unless a lower limitation applies to your claim under clause 29 below. This maximum amount will only be payable where everything has gone wrong and you have not received any benefit at all from your journey.

29. Where any claim or part of a claim (including those involving death or personal injury) concerns or is based on any travel arrangements (including the process of getting on and/or off the transport concerned) provided by any air, sea or rail carrier to which any international convention or EU regulation applies, the maximum amount of compensation we will have to pay you will be limited. The most we will have to pay you for that claim or that part of a claim if found liable to you on any basis is the most the carrier concerned would have to pay under the international convention or regulation which applies to the travel arrangements in question (for example, the Warsaw Convention as amended or unamended and the Montreal Convention for international travel by air and/or for airlines with an operating licence granted by an EU country, the EC Regulation on Air Carrier Liability No 889/2002 for national and international travel by air, the Athens Convention for international travel by sea (as amended by the 2002 Protocol where applicable) and COTIF, the Convention on International Travel by Rail). Please note: where a carrier or hotelier would not be obliged to make any payment to you under and in accordance with the applicable international convention or regulation in respect of a claim or part of a claim, we similarly are not obliged to make a payment to you for that claim or part of the claim. When making any payment, we are entitled to deduct any money which you have received or are entitled to receive from the carrier for the claim in question. Copies of the applicable international conventions and regulations are available from us on request.

30. Please note, we cannot accept any liability for any damage, loss, expense or other sum(s) of any description (1) which on the basis of the information given to us by you concerning your booking prior to our accepting it, we could not have foreseen you would suffer or incur if we breached our contract with you or (2) which did not result from any breach of contract or other fault by ourselves or our employees or, where we are responsible for them, our suppliers. Additionally, we cannot accept liability for any business losses including self-employed loss of earnings.

31. You must provide ourselves and our insurers with all

assistance we may reasonably require. You must also tell us and the supplier concerned about your claim or complaint as set out below. If asked to do so, you must transfer to us or our insurers any rights you have against the supplier or whoever else is responsible for your claim or complaint (if the person concerned is under 18, their parent or guardian must do so). You must also agree to cooperate fully with us and our insurers if we or our insurers want to enforce any rights which are transferred.

Suppliers

32. Many of the services which make up your journey are provided by independent suppliers. Those suppliers provide these services in accordance with their own terms and conditions. Some of these terms and conditions may limit or exclude the supplier's liability to you, usually in accordance with applicable international conventions (see clause 29).

33. Copies of the relevant parts of these terms and conditions and of the international conventions are available on request from ourselves or the supplier concerned.

Force Majeure

34. Except where otherwise expressly stated in these terms and conditions we regret we cannot accept liability or pay any compensation where the performance or prompt performance of our obligations under our contract with you is prevented or affected by or you otherwise suffer any damage, loss or expense of any nature as a result of Force Majeure. "Force Majeure. Force Majeure means any event which we or the supplier of the service(s) in question could not, even with all due care, foresee or avoid. Such events are likely to include (whether actual or threatened) an act of God, war, terrorism, fire, flood or any other extreme weather conditions exceptional water levels, lock damage, loss of power, epidemics or pandemics, industrial disputes, slow-downs or other strike activities, political unrest, riots or civil disturbances, prohibitions or acts of Federal, State, Territory, local government, quasi-government bodies or other authorities (including, in each case, their duly constituted or appointed agents), inability to obtain the necessary licence of consent and delays caused by sub-contractors, suppliers or other third parties (including telecommunications carriers), material shortages, any border closures by any country or the UK Government, or other disruptions to the journey beyond our control, set out in clause 25 (which includes the behaviour of any passenger(s) on the flight who, for example, fails to check in or board on time).

Risk and travel insurance

35. You acknowledge and accept that there are inherent risks associated with our journeys for example events of Force Majeure, hazards of travelling in undeveloped areas, travel by boat, train, automobile, aircraft or other means of transportation particularly in underdeveloped countries or more remote locations.

36. We strongly advise you to take out adequate and appropriate travel insurance to cover as a minimum cancellation by you, loss of luggage, early return following death of a relative and emergency repatriation in the event of accident or illness.

37. Please read your policy details carefully and take them with you on your journey. It is your responsibility to ensure that the insurance cover you purchase is suitable and adequate for your particular needs.

Service availability, itinerary changes and travel advice

38. During local or national holidays, certain facilities such as museums and restaurants, sightseeing tours and shopping may be limited or not available. Alternatives will be offered if possible.

39. The Foreign and Commonwealth Office may have issued information about your journey destination. You are advised to check this information on the internet at www.gov.uk/foreign-travel-advice.

Smoking

40. Smoking (including e-cigarettes) is not permitted inside tourist coaches and such other places as are prohibited by us or our suppliers. We will use reasonable endeavours to ensure there are frequent stops on any coach trip and there are permitted areas outside decks on-board some cruise vessels which are available for smoking, however we cannot guarantee these facilities will be available.

Baggage allowance and luggage restrictions

41. You are entitled to carry one suitcase per person with the total sum of its length, width and height not exceeding 76 x 53 x 28cm/30 x 21 x 11 in and weight up to 23kg (50 lbs) dependent on any airline restrictions. Personal and valuable items such as make-up, cameras, medication, passport, money/credit cards etc. should be carried in a travel bag or on your person. You must ensure that luggage meets the weight requirements as overweight or oversize items will not be carried. Some carriers may impose a small surcharge per day for a second suitcase per person. Excess baggage is always at your cost.

Young travellers

42. Travellers who are less than 21 years old on the departure date must be accompanied by and share a cabin/room with an adult aged 21 or over. Children under 12 years of age are not encouraged and are accepted or rejected at our sole discretion. This is a condition of carriers and cruise operators we use.

Complaints and Damage

43. If a problem occurs during your journey, you must advise our representative immediately so that steps can be taken to resolve the matter and you can continue to enjoy the remainder of your journey. You must also advise the supplier concerned. Any verbal notification must be put in writing and given to our representative/agent and

the supplier as soon as possible. If we do not have or you cannot contact our local representative or agent and any complaint or problem is not resolved to your satisfaction by the supplier, you must contact us in the UK using the contact details we have provided you with during your holiday, giving us full details and a contact number. Until we know about a complaint or problem, we cannot begin to resolve it. Most problems can be dealt with quickly. If you remain dissatisfied, any complaint must be made either by telephone or in writing to us giving full details within 30 days of the end of the journey. If you fail to follow this procedure, your right to claim compensation you may otherwise have been entitled to may be affected or even lost as a result.

Disputes arising out of, or in connection with your booking which cannot be amicably settled may be referred to ABTA's Alternative Dispute Resolution Scheme. The scheme provides for a simple and inexpensive method of resolving disputes and, where appropriate, arbitration on documents alone with restricted liability on the customer in respect of costs. Full details will be provided on request or can be obtained from the ABTA website (www.abta.com). The arbitration scheme does not apply to claims for an amount greater than £5,000 per person. There is also a limit of £25,000 per booking. Neither does it apply to claims which are solely in respect of physical injury or illness or their consequences. The scheme can however deal with compensation claims which include an element of minor injury or illness subject to a limit of £1,500 on the amount the arbitrator can award per person in respect of this element. Your application for arbitration and other required documents must be received by ABTA within 18 months of your return from the holiday. Outside this time limit arbitration under the scheme may still be available if we agree, although the ABTA Code does not require such agreement. For injury and illness claims, you can request the ABTA mediation procedure and we have the option to agree to this. Where we act as agent, please bear in mind that your contract is with the supplier of the arrangements concerned. Unless the supplier is also a member of ABTA, only disputes relating to our actions as agent can be dealt with by the arbitration scheme or mediation procedure and not complaints about the arrangements themselves or the acts/omissions of the supplier.

44. When you book with us, you accept responsibility for any damage or loss caused by you or any member of your party. Full payment for any such damage or loss (reasonably estimated if not precisely known) must be made direct to the accommodation owner or manager or other supplier or to us as soon as possible. If the actual cost of the loss or damage exceeds the amount paid where estimated, you must pay the difference once known. If the actual cost is less than the amount paid, the difference will be refunded. You will also be responsible for meeting any claims subsequently made against us and all costs incurred by us (including our own and the other party's full legal costs) as a result of your actions. You should ensure you have appropriate travel insurance to protect you if this situation arises.

Included in your fare

45. Airfares from the UK (unless specified at the time of booking, e.g. selected special offers), coach and cruise travel, services of a Cruise Director (if applicable) and/or Tour Director; local guide in destination (if applicable), airport transfers outside of the United Kingdom, port charges, meals as specified in your Itinerary, economy class group flights and air taxes as set out in your specific itinerary, accommodation, sightseeing and admissions and other services as expressly indicated in the itinerary, all gratuities and tipping on land journeys except as set out below.

NOT included in your fare

46. Unless expressly listed in your Itinerary as an inclusion, your journey price does not include airfares; airline taxes; shore excursions on ocean cruises; additional optional activities; accommodation upgrades; overnight accommodation required to meet your journey and/or flight connections; gratuities and tips to any staff on cruise ships not operated by us (unless otherwise expressly advised), meals not specified in the itinerary, drinks, laundry, passport fees, visas, vaccinations, medical assistance, government taxes and charges (excluding VAT), expenses of a personal nature, travel between train stations and any other items which are not expressly included in the cost of your journey. Changes to flight schedules may require additional overnight accommodation at either commencement or completion of journey which is at your own expense. For the avoidance of doubt hotel accommodation is not provided on an all-inclusive basis.

Airfare conditions

47. Air travel is based on a specific class and is subject to availability at time of booking. If booking a promotional journey, all inclusions and conditions may differ. Please check promotional booking conditions. Full details and conditions may be obtained from your travel consultant. Changes to original tickets will incur amendment or cancellation fees, are subject to availability and surcharges may apply. Please see clauses 21 and 22 above. Please note: all airfares are subject to routing restrictions, and route availability.

Flights

48. We are not always in a position at the time of booking to confirm the flight timings which will be used in connection with your flight. The flight timings shown in our brochure, on our website and/or detailed on your confirmation invoice are for guidance only and are subject to alteration and confirmation. Flight timings are outside our control. They are set by airlines and are subject to various factors including air traffic control restrictions, weather conditions, potential technical problems and the ability

of passengers to check in on time. The actual times will be those shown on your tickets which will be dispatched to you approximately two weeks before departure. Please note, flights may operate indirect. You must accordingly check your tickets very carefully immediately on receipt to ensure you have the correct flight times. It is possible that flight times may be changed even after tickets have been dispatched - we will contact you as soon as possible if this occurs.

49. In accordance with the UK's Retained EU Legislation on EU Directive (EC) No 2111/2005, we are required to bring to your attention the existence of a list which contains details of air carriers that are subject to an operating ban within the UK. The Community list is available for inspection at <https://info.caa.co.uk/uk-regulations>. We are also required to advise you of the carrier(s) (or, if the carrier(s) is not known, the likely carrier(s)) that will operate your flight(s) at the time of booking. Where we are only able to inform you of the likely carrier(s) at the time of booking, we shall inform you of the identity of the actual carrier(s) as soon as we become aware of this. Any change to the operating carrier(s) after your booking has been confirmed will be notified to you as soon as possible. If the carrier with whom you have a confirmed reservation becomes subject to an operating ban as above as a result of which we/the carrier are unable to offer you a suitable alternative the provisions of clause 18 and 19 will apply. Any change in the identity of the carrier, flight timings, and/or aircraft type (if advised) will not entitle you to cancel or change to other arrangements without paying our normal charges except where specified in these conditions.

50. If you suffer a delay to your outbound travel arrangements, we will do our best to assist you make the start of your journey or, if this cannot be achieved, join it as soon as possible any costs we incur in making any alternative arrangements in this situation will be your responsibility. In the event of a flight delay, the airline concerned may provide refreshments and/or other assistance depending on factors such as the length of the delay, time of day and number of passengers affected. We cannot accept liability for any delay which is due to any of the reasons set out in clause 25 (which includes the behaviour of any passenger(s) on the flight who, for example, fails to check in or board on time).

51. If your flight is cancelled or delayed, your flight ticket is downgraded or boarding is denied by your airline, depending on the circumstances, the airline may be required to pay you compensation, refund the cost of your flight and/or provide you with accommodation and/or refreshments under EC Regulation No 261/2004 - the Denied Boarding Regulations 2004. Where applicable, you must pursue the airline for the compensation or other payment due to you. All sums you receive or are entitled to receive from the airline concerned by virtue of these Regulations represent the full amount of your entitlement to compensation or any other payment arising from such cancellation, delay, downgrading or denied boarding. This includes any disappointment, distress, inconvenience or effect on any other arrangements. The fact a delay may entitle you to cancel your flight does not automatically entitle you to cancel any other arrangements even where those arrangements have been made in conjunction with your flight. We have no liability to make any payment to you in relation to the Denied Boarding Regulations or in respect of any flight cancellation or delay, downgrading of any flight ticket or denial of any boarding as the full amount of your entitlement to any compensation or other payment (as dealt with above) is covered by the airline's obligations under the Denied Boarding Regulations. If for any reason, we make any payment to you or a third party which the airline is responsible for in accordance with the Denied Boarding Regulations, you must, when requested, assign to us the rights you have or had to claim the payment in question from the airline. If the airline does not comply with these rules, you may complain to the CAA on 020 7453 6888 or by e-mail to passengercomplaints@caa.co.uk or see www.caa.co.uk - Referring Your Complaint to the CAA.

Transfers

52. These are only available on the day your journey commences and the day your cruise/journey terminates at designated times. Transfers outside these times will be at your expense and arrangement. If you have purchased pre and post journey hotel accommodation through us, you will be provided with airport transfers to/from your hotel to the relevant gateway airport and to the ship. If your airline booking is not made by us, you must ensure your flight details are provided to us (this can be entered by Tour Personaliser at www.scenic.co.uk). Please note: No refund will be given for unused transfers. Transfers cannot be routed to other pick-up points or destinations. Passengers who miss the pre-booked transfer will be responsible for making their own way to/from the ship/rail station or hotel at their own expense. Transfers must be booked and flights advised to us a minimum of 60 days prior to travel otherwise transfers cannot be guaranteed. This may not apply to all journeys. Please ask at time of booking. You will be responsible for any excess baggage charges. You acknowledge and agree we have no liability to you for any loss, damage, breach of contract or negligence relating to your luggage during this portion of the journey and in the event of any dispute or claim including for loss, damage, breach of contract or negligence arising from the conduct of the Service Provider, you must pursue your claim directly against the relevant Service Provider.

Hotel accommodation

53. IMPORTANT: Unless otherwise expressly stated in the description of the journey in question or expressly advised by us to you, overnight accommodation required to meet journey and/or flight connections is not included in the journey price and is at your own expense.

We may substitute hotel accommodation of a similar

standard in the place of the advertised hotel due to hotel availability issues. Any changes will be notified once confirmed with the hotel.

Although we have taken reasonable steps to secure the most suitable hotel accommodation in the area of the journey, we are not liable to you for the quality, size or fitness of hotel rooms.

Passports and visas

54. British (citizen) passport holders are recommended to have a valid passport with at least 6 months validity from return date. It is your responsibility to ensure any visas required for countries to be visited on the journey have been obtained prior to the journey departure date. Failure to obtain correct documentation will mean you may be unable to participate in particular shore excursions and may be denied boarding and/or entry into certain countries. Passport and visa entry requirements and costs are your sole responsibility. We cannot accept any liability if you are refused entry onto any transport or into any country due to failure on your part to carry correct documentation. If failure to have any necessary travel or other documents results in fines, surcharges or other financial penalty being imposed on us, you will be responsible for reimbursing us accordingly.

Please note: You must ensure that you obtain prior to the journey departure date all required entry visas for all countries to be visited during the journey, as failure to obtain correct documentation may affect Your participation in certain shore excursions and entry to certain countries during the journey.

We recommend that you check www.gov.uk/foreign-travel-advice for the latest entry requirements for the countries you are due to visit.

55. A full British passport presently takes approximately 4 to 6 weeks to obtain. If you are 16 or over and have not yet got a passport, you should apply for one at least six weeks before your departure from the UK. The UK Passport Service has to confirm an applicant's identity before issuing their first passport and will ask them to attend an interview in order to do this. If you are not a British citizen or hold a non-British passport, you must check passport and visa requirements with the Embassy or Consulate of the country(ies) you are travelling through and to which you are intending to travel. Please note, all requirements may change and all clients must check the up-to-date position in good time before departure with the Embassy or consulate of the country(ies) you are travelling through and to.

56. It is your responsibility to ensure you are aware of all recommended vaccinations and health precautions in good time before departure. Details are available from your GP surgery and from the National Travel Health Network and Centre www.nathnac.org. Information on health abroad is also available on www.nhs.uk/Livewell/Travelhealth. Vaccination and other health requirements/recommendations are subject to change at any time for any destination. Please therefore check with a doctor or clinic not less than six weeks prior to departure to ensure that you have met the necessary requirements and have the applicable information.

57. It is the lead name's responsibility to ensure that all members of the party are in possession of all necessary travel and health documents before departure. All costs incurred in obtaining such documentation must be paid by you. We regret we cannot accept any liability if you are refused entry onto any transport or into any country due to failure on your part to carry all required documentation. If failure to have any necessary travel or other documents results in fines, surcharges or other financial penalty, costs or expenses being imposed on or incurred by us, you will be responsible for reimbursing us accordingly.

Financial security

58. We hold an Air Travel Organiser's Licence issued by the Civil Aviation Authority (ATOL number 9294). When you buy an ATOL protected flight or flight inclusive holiday from us, you will receive an ATOL Certificate. This lists what is financially protected, where you can get information on what this means for you and who to contact if things go wrong. We, or the suppliers identified on your ATOL Certificate, will provide you with the services listed on the ATOL Certificate (or a suitable alternative). In some cases, where neither we nor the supplier are able to do so for reasons of insolvency, an alternative ATOL holder may provide you with the services you have bought or a suitable alternative (at no extra cost to you). You agree to accept that in those circumstances the alternative ATOL holder will perform those obligations and you agree to pay any money outstanding to be paid by you under your contract to that alternative ATOL holder. However, you also agree that in some cases it will not be possible to appoint an alternative ATOL holder, in which case you will be entitled to make a claim under the ATOL scheme (or your credit card issuer where applicable). If we, or the suppliers identified on your ATOL certificate, are unable to provide the services listed (or a suitable alternative, through an alternative ATOL holder or otherwise) for reasons of insolvency, the Trustees of the Air Travel Trust may make a payment to (or confer a benefit on) you under the ATOL scheme. You agree that in return for such a payment or benefit, you assign absolutely to those Trustees any claims which you have or may have arising out of or relating to the non-provision of the services, including any claim against us, the travel agent or your credit card issuer where applicable. You also agree that any such claims may be re-assigned to another body, if that other body has paid sums you have claimed under the ATOL scheme. Please note: Not all holiday or travel services offered and sold by us will be protected by the ATOL scheme *the air inclusive holidays and flights we arrange are ATOL protected providing they are made available in the UK. For further information, visit the ATOL website at www.atol.org.uk.

59. We are a member of ABTA with membership number Y6328. ABTA and ABTA members help holidaymakers to get the most from their travel and assist them when things do not go according to plan. We are obliged to maintain high standards of service to you by ABTA's Code of Conduct. For further information about ABTA, the Code of Conduct and the dispute resolution scheme available to you if you have a complaint, contact ABTA, 30 Park Street, London SE1 9EQ. Tel: 020 3117 0500 or www.abta.com.

If your holiday does not include flights, ABTA will financially protect your holiday by ensuring you receive a refund or, if your arrangements include return travel to the UK (other than flights) you are returned to the UK in the event that your holiday cannot be provided as a result of our insolvency. Please go to www.abta.com for a copy of the guide to ABTA's scheme of Financial Protection.

Journey Participation

60.a Facilities: It is important to note that:

(a) Requests for modified rooms must be made at the time of booking and are subject to availability;

(b) Wheelchairs and walkers can be carried in the luggage compartment of motor coaches subject to space limitations.

(c) Some shore excursions will be 'wet landings' requiring you to either walk through water and / or onto wet and potentially slippery surfaces. If you choose to participate in any sightseeing expeditions forming part of the journey, you should be in appropriate physical condition and appropriately attired to deal with these conditions.

60.b Our discretion: We may, in our absolute discretion, decline your booking if we are of the view that:

- (a) We cannot adequately provide for any or all of your special needs;
- (b) Your health, safety or enjoyment, or that of any other passengers attending the journey may be at risk; or
- (c) You cannot or will not abide by any reasonable directions of the Tour Director or Cruise Director.

Coaches

61. (a) Seat rotation: To ensure all passengers have the opportunity to enjoy front and window seats, a daily seat rotation system is employed on all of our coaches and you must follow the seat rotation system.

(b) Travel sickness: If you suffer from travel sickness, you should arrange medication or other alternatives to treat symptoms, as we cannot make allowances for this.

Medical Services

62. Please consult your doctor before departure to ensure you have an adequate level of fitness and health.

Vaccinations: It is your responsibility to ensure you have all required vaccinations for your journey and we recommend you refer to <http://www.nhs.uk/Conditions/Travel-immunisation/Pages/Introduction.aspx> for full details and also consult your doctor.

You will not receive a refund if you are unable to be vaccinated and if as a result decide not to complete the journey.

Sightseeing tours

63. Sightseeing: Sightseeing in many historic towns and cities can only be undertaken by walking tours as motorcoach access is not possible. Consequently, a reasonable level of fitness is required as the sightseeing tour may involve steps and extensive walking over uneven surfaces.

(b) Scenic Freechoice: All Scenic Freechoice activities and Scenic Freechoice Dining can be booked whilst on journey with your Cruise Director or Tour Director (unless otherwise stated) and are subject to availability, seasonal and operational factors. Some activities require a minimum or maximum number of participants to operate.

Scenic Enrich & Scenic Sunset Drinks

64. Scenic Enrich and Scenic Sunset Drinks: It may not always be possible to offer every Scenic Enrich activity and Scenic Sunset Drinks in the journey brochure on your journey. Wherever possible, suitable alternatives will be provided without liability to you.

Cruises

65. If your journey includes a cruise, the following provisions apply:

(a) Deck plan: The deck plan, cabin sizes, images, inclusions and cabin layout in the journey brochure are indicative only and may vary. Pictured representations of cabins or rooms in journey brochures are not drawn to scale. Suite dimensions within each category may vary in size depending on their location on each deck. Suite measurements are based on gross calculations and include internal technical spaces.

(b) Cruise Cabins: Your journey price is based on the cabin category indicated in the journey brochure. Upgrades are subject to availability and will be at an additional cost.

(c) Port arrival and departure times: arrival and departure times are an indication only and are always subject to change without notice.

(d) Cruise Itinerary: we reserve the right to substitute or cancel scheduled ports of call which, in our sole judgement and discretion, is justified for any reason and to do so without liability for any loss whatsoever to guests as a result of said change(s).

(e) Shore Excursions: Shore excursions provided by independent third-party Service Providers are at your own expense and can be purchased prior to your journey departure date. We recommend booking shore excursions at least 120 days prior to your journey departure date.

(f) Photography: Our journeys offer some of the most spectacular and beautiful photographic scenery in the

world. However, we cannot guarantee that every scene or highlighted featured in a journey brochure or itinerary will be available on each journey. No refund or other compensation will be available for any resulting missed scene or photographic "opportunity".

(g) Smoking: Smoking is limited to designated smoking areas during your journey.

(i) You acknowledge that we may restrict smoking to specific times and locations during your cruise for the comfort of all passengers.

(ii) Smoking is not permitted on coaches or such other places as nominated by us from time to time.

(iii) Although we will use reasonable endeavours to ensure there are opportunities for you to smoke during the journey, we cannot guarantee such opportunities will be available.

(h) Noise, vibration and odour: While the Operators take reasonable steps to minimise noise, vibration and odours on the cruise vessels, you acknowledge and accept that some noise, vibration and intermittent odours may be experienced on vessels, and that we accept no responsibility, and will not be liable to you in relation to any such noise, vibration or odour.

(i) Docking Position: During port stops, vessels may dock side by side, obstructing views and requiring you to pass through other vessels to embark and disembark. You agree and acknowledge that you will have no claim in respect of any such matters.

(j) Medical Services:

(i) River cruise ships do not carry a doctor on board (except in Russia), however medical services may be called at your own expense.

(ii) Due to the large number of passengers on board, we cannot provide a personal escort for medical visits.

(iii) We are not, and our Service Providers and the Operators are not, liable regarding the provision of any medical care you may require or choose to accept during your journey.

(k) Currency and credit cards

(i) All purchases on board a charge to your shipboard account. The on-board currency on river cruises is the US dollar.

(ii) Shipboard accounts may be paid by US dollar or credit card.

(l) Internet Service: Internet facilities are available on board your ship at no additional charge.

(i) Complimentary Internet service does not apply to any third-party suppliers.

(ii) Internet availability and quality may vary from country to country and can also be affected by technical issues, weather or unfavourable terrain and other factors outside our control.

(iii) We do not guarantee the availability or quality of Internet connections or services.

(m) All-inclusive beverages: If your journey includes an all-inclusive beverage package, the following provisions apply:

(i) all standard beverages are included in the journey price whilst you are on board Scenic Spirit This includes beer, wine, soft drinks and standard spirits. It also includes daily replenishment of the suite minibars.

(ii) Selected items such as high-end spirits, including malt whiskey, French champagne and selected wines are not included in the package and may be available at an additional charge.

(iii) Responsible service of alcohol is adhered to by all staff on board of all vessels and we reserve the right to refuse service.

(iv) The all-inclusive beverages package does not apply to any third-party suppliers.

Drones

66. (a) General prohibition: Unless provided by us or an Operator as part of an organised activity during your journey, the use of Drones is strictly prohibited at all times on your journey.

(b) Legal restrictions: You should also be aware that, in addition to the prohibition in paragraph (a), the use of Drones is regulated or prohibited by law in many locations and unlawful use may result in arrest or prosecution by the relevant authorities.

(c) Organised Activities: If we or an Operator allow you to operate a Drone as part of an organised activity during your journey, you must strictly comply with all instructions of the activity leader.

Pictures, images and data protection

67. Maps or journey depictions contained in journey brochures or any other brochures we issue are intended as an indication only and should not be relied upon as the actual route to be taken during the journey. All images in journey brochures represent typical scenes and descriptive detail for each journey, however it is possible that the particular subject matter may not be seen or experienced on your journey. Also, some pictures may have been digitally enhanced.

68. For the purposes of the Data Protection Act 1998 we are a data controller. Our privacy policy is available to view on our website www.scenic.co.uk and sets out how we collect and use the personal information you provide us with. We will only process personal data as set out in our privacy policy (as amended or added to) or otherwise notified to or agreed by you or as we are otherwise permitted to do in accordance with the Data Protection Act 1998.

69. The information contained in our brochure, on our website www.scenic.co.uk and in our other advertising material is believed correct to the best of our knowledge at the time of printing or publication. However, errors may

occasionally occur and information may subsequently change. You must therefore ensure you check all details of your chosen holiday (including the price) with us or your travel agent at the time of booking.

Promotions

70. Please note that if a different promotion becomes available after your booking has been confirmed this is not applicable to your booking. Scenic does not back date our promotions.

71. The Foreign and Commonwealth Office may have issued information about your journey destination. You are advised to check this information on the internet at www.gov.uk/foreign-travel-advice.

Destination Specific Terms

72. Medical Conditions: We strongly recommend a visit to your doctor prior to your journey.

73. Scenic Sunset Drinks: Depending on sailing date, the event may not be held during sunset.

74. Royal Panorama Suite on board credit: Guests receive \$50 USD per person to their shipboard account which can be used in the Wellness Centre. This is not applicable to other services whilst on board and is not redeemable for cash.

75. Visas: A visa is required to visit Vietnam, Cambodia, Laos and Myanmar. For Vietnam a Visa or Visa Approval letter must be obtained prior to departure. For other destinations a visa can be purchased upon arrival.

76. Not later than 15 days before the journey departure date, expectant mothers are required to supply a medical certificate establishing their fitness for travel at the time they are due to travel. The certificate must be signed by a medical practitioner, include the estimated delivery date and be dated not earlier than 30 days before the journey departure date. In any event, we are unable to accommodate, and will not allow to participate in the journey, any woman who has entered her twenty-fourth (24th) week of pregnancy prior to the journey departure date, or who will do so at any time during the journey, and, to the maximum extent permitted by law, will not be responsible or liable for any complication relative to any pregnancy during the entire duration of the cruise or thereafter. Additionally, airlines may have restrictions that may differ from ours. Please contact your travel professional or airline for details.

77. Unscheduled Embarkation / Disembarkation: International cabotage laws may prohibit guests from embarking or disembarking their voyage in any port except the main scheduled embarkation and disembarkation ports. Only those guests with a medical emergency may be allowed to embark or disembark the Cruise Vessel at an unscheduled embark / disembark port. If an unscheduled embarkation or disembarkation is permitted as a result of an emergency, those guests may incur additional charges intended to cover any fine or penalty levied against Scenic and any other additional costs. Such additional costs will be added to the guests' on board account prior to disembarking.

78. We strongly recommend that you take out comprehensive travel insurance with a reputable insurance company to cover you against risks associated with your cruise/journey including cover for loss of luggage, medical expenses, costs and expenses incurred due to cancellations, delays or other disruptions or medical evacuation in remote areas.

79. Service Animals: Due to the sensitive environments and regulatory regulations of the region travelled to, we are unable to accept service animals on the cruise.

80. Earlybird Fares are strictly limited and subject to availability.

81. Future Travel Voucher

If we Issue a Future Travel Voucher to you:

(i) You may apply it towards any future booking for a Journey with a Journey Departure Date within 24 months after the date on which we cancel your booking; subject to availability and any Future Travel Voucher capacity limits applicable to your selected Journey or cruise;

(ii) If your original booking was for an ocean or river cruise, the Future Travel Voucher can only be applied to available ocean and river cruises within the Scenic Group (Scenic Luxury Cruises & Journeys and Emerald Cruises).

(ii) If your original booking was for a land Journey, the Future Travel Voucher can be applied to available land Journeys or ocean and river cruises within the Scenic Group (Scenic Luxury Cruises & Tours and Emerald Cruises).

(iii) You may, with our prior written consent, which we will not unreasonably refuse, transfer it to another person to apply towards any future Booking for a Journey with a Journey Departure Date within 24 months after the date on which we cancel your booking;

(v) its use for any future booking is subject to availability;

(vi) it cannot be applied against stand-alone products or upgrades from third parties or from service providers in conjunction with the standard journey itinerary.

(vii) If you do not use the Future Travel Voucher prior to the expiry date you will be entitled to a refund.

(viii) You (or the person to whom It is transferred) must pay any shortfall between the value of the Future Travel Voucher and the Journey price for the new booking.

FULL TERMS AND CONDITIONS can be found online at www.scenic.co.uk/terms-and-conditions (subject to change).

Published December 2022.

Other Destinations

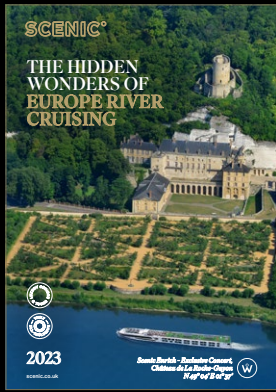

2023
Europe
River Cruising

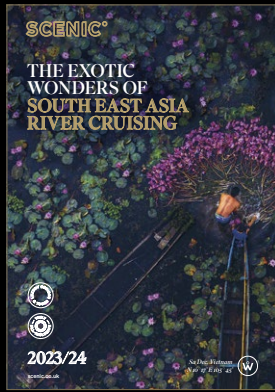

2023/24
South East Asia
River Cruising
& Land Journeys

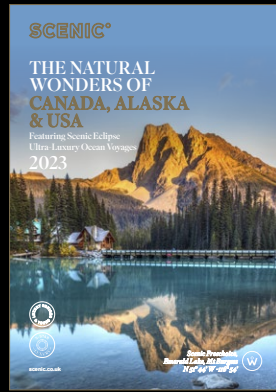

2023
Canada, Alaska & USA
Land Journeys



2023/24
Australia & New Zealand
Land Journeys

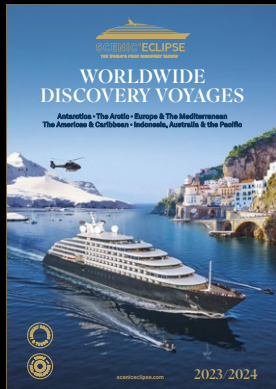

2023-24
Worldwide
Discovery
Voyages

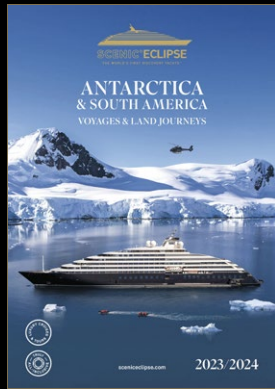

2023-24
Antarctica &
South America
Voyages & Land
Journeys

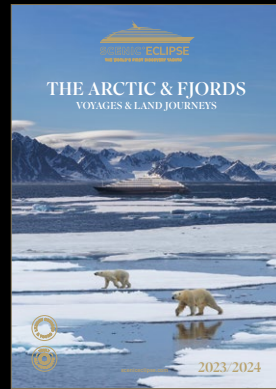

2023-24
The Arctic
& Fjords
Voyages & Land
Journeys



2023-24
Australia, Indonesia
& The Pacific
Voyages & Land
Journeys

To request a brochure, visit [scenic.co.uk/brochures](https://www.scenic.co.uk/brochures)

Call
0808 258 3966
visit [scenic.co.uk](https://www.scenic.co.uk)
or contact your local Travel Agent



Scenic Offices

UK Office
1st Floor
4 Piccadilly Place
Manchester
M1 3BN
[scenic.co.uk](https://www.scenic.co.uk)

Australia Offices
25 Watt Street
Newcastle
NSW 2300
[scenic.com.au](https://www.scenic.com.au)

Level 15
56 Pitt Street
Sydney
NSW 2000
[scenic.com.au](https://www.scenic.com.au)

Canada Office
Suite 1025,
401 West Georgia Street
Vancouver
BC V6B 5A1
[scenic.ca](https://www.scenic.ca)

USA Office
4000 Hollywood Blvd.
Suite 625-S
Hollywood
FL 33021
[scenicusa.com](https://www.scenicusa.com)

